

Langlade Cty-Perch Lake Electric

8/27/2024

Bidder	<u>peiper Elect. Exist/min</u>	Bid \$	<u>238,263.38</u>
Bidder	<u>Andraschko plumb 800 amp</u>	Bid \$	<u>247,500.00</u>
Bidder	<u>Andraschko plmb. <sup>elect.</sup> Exist/min</u>	Bid \$	<u>212,000.00</u>
Bidder	<u>peiper Elect. <sup>elect</sup> 800 amp</u>	Bid \$	<u>2162,968.40</u>
Bidder	_____	Bid \$	_____
Bidder	_____	Bid \$	_____
Bidder	_____	Bid \$	_____
Bidder	_____	Bid \$	_____
Bidder	_____	Bid \$	_____
Bidder	_____	Bid \$	_____
Bidder	_____	Bid \$	_____

Winning Bidder: Andraschko Plumbing & Electric LLC.

NOTES: 800 Amp Service



# BID FORM

## PERCH LAKE CAMPSITE ELECTRIC SERVICE

After having examined the bidding and specification documents, including the INVITATION FOR BIDS, INSTRUCTIONS TO BIDDERS, REQUIRED CLAUSES, GENERAL CONDITIONS, INSURANCE REQUIREMENTS, PLANS AND TECHNICAL SPECIFICATIONS, and having understood that Langlade County reserves the right to reject any or all bids, or parts thereof, and to award to the bidder who in the judgment of the County will best serve the County; the undersigned proposes to furnish all labor, materials, and services essential to the successful completion of the contract work for the following work optio

**A. Addenda**

I/we, the bidder, acknowledge receipt of Addenda:

Number \_\_\_\_\_ dated N/A

Number \_\_\_\_\_ dated N/A

**B. Lump Sum price to furnish, deliver and perform all work indicated on plans, specifications and details for DESIGN/BUILD OF ELECTRICAL SYSTEM TO SERVICE PERCH LAKE CAMPGROUND**

**a. Phase 1-**

- Install 1 Exterior Distribution Panel on backside of Restroom Building #2
- Install exterior lighting on 3 sides of Restroom Building #2
- Install underground service lines and 50/30/20 AMP RV Service Pedestals according to limitations above in the following locations :
  - 2 pedestals at Site 56 and Site 2
  - 1 pedestal at sites 2,3,4,30,31,32,33,35,36,37,38,39,40, and 41
- Reclaim and reseed all disturbed areas.

**TOTAL COST FOR COMPLETION OF PHASE 1 ONLY:**

81,858.44

\$ \_\_\_\_\_

**b. Phase 2-**

- Install 1 Exterior Distribution Panel on backside of Restroom Building #3
- Install exterior lighting on 3 sides of Restroom Building #3
- Install underground service lines and 50/30/20 AMP RV Service Pedestals according to limitations above in the following locations:
  - 1 pedestal at sites 5,6,7,8,27,28,29,42,43,44,45,46,47,57
- Reclaim and reseed all disturbed areas.

**TOTAL COST FOR COMPLETION OF PHASE 2 ONLY:**

53,218.75  
\$ \_\_\_\_\_

**c. Phase 3-**

- Install 1 Exterior Distribution Panel on backside of Restroom Building #4
- Install exterior lighting on 3 sides of Restroom Building #4
- Install underground service lines and 50/30/20 AMP RV Service Pedestals according to limitations above in the following locations:
  - 1 pedestal at sites 25,26,49,50,51,52,43,54,55,56
- Reclaim and reseed all disturbed areas.

**TOTAL COST FOR COMPLETION OF PHASE 3 ONLY:**

41,211.26  
\$ \_\_\_\_\_

**d. Phase 4-**

- Install 1 Exterior Distribution Panel on backside of Restroom Buildings #5 & #6
- Install exterior lighting on 3 sides of Restroom Building #5 & #6
- Install underground service lines and 50/30/20 AMP RV Service Pedestals according to limitations above in the following locations:
  - 1 pedestal at sites 9,10,11,12,13,14,15,16,17,18,19,20,21,22,23,24
- Reclaim and reseed all disturbed areas

**TOTAL COST FOR COMPLETION OF PHASE 4 ONLY:**

61,974.93  
\$ \_\_\_\_\_

**TOTAL COST FOR COMPLETION PHASES 1, 2, 3 & 4) CONCURRENTLY:**

238,263.38  
\$ \_\_\_\_\_

**C. Certification**

I/we understand this bid is good for ninety (90) days and if accepted by the County will be used as the basis for a contract for the work covered within the bidding documents and specifications and the contract documents.

Company: Pieper Electric Inc  
(type or Print)

Company Address: W4618 County Road G Merrill WI 54452  
(type or Print)

Phone: 715-297-1070  
(type or Print)

E-mail: trent.vollrath@pieperpower.com

Name/Title: Trent Vollrath Department Manager  
(type or Print)

Authorized Signature: Trent Vollrath  
(Signature)

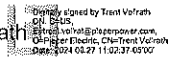



LANGLADE COUNTY  
FORESTRY, PARKS, AND  
RECREATION DEPARTMENT  
1633 NEVA ROAD  
ANTIGO, WISCONSIN 54409



BID SPECIFICATIONS, BID FORMS  
AND RELATED DOCUMENTS FOR  
**PERCH LAKE CAMPSITE ELECTRIC SERVICE**

AUGUST 8, 2024

\*Minimum sized services for existing sites, no  
future sites.





**TABLE OF CONTENTS**

**PAGE**

---

INVITATION FOR BIDS.....1

INSTRUCTIONS TO BIDDERS.....3

REQUIRED CLAUSES.....3

GENERAL CONDITIONS.....3

INSURANCE REQUIREMENTS.....4

HOLD HARMLESS.....5

BID FORM.....6

**INVITATION FOR BIDS FOR  
PERCH LAKE CAMPSITE ELECTRIC SERVICE**

**Purpose:** Langlade County is soliciting bids from electrical companies to design and build an electrical service system to service the newly built Perch Lake Campground located at N10571 Clear Lake Rd, Elcho, WI 54428

- A. Contracting company shall design, engineer and install electrical system capable of properly servicing 50/30/20 AMP RV pedestal sites at campsites from Wisconsin Public Service locations to pedestal sites. WPS service will be no more than 15 feet from existing restroom buildings.
- B. To protect campground users that may pound stakes electrical service lines shall not be more than 3 feet from existing gravel roadways or established camping pad
- C. Pedestal locations shall be on the righthand side of camping pad as looking from the roadway and shall be no more than 10 feet from the rear of the established camping pad.
- D. Design shall include installation of exterior service panels to be located on the back side of existing restroom buildings.
- E. Design shall also include installation of exterior lighting on three sides of the exiting restroom building where the distribution panel is installed.
- F. Work will be bid as 4 phases with the County decision on any or all of the phases dependent upon County approval of WPS service locations.
  - a. **Phase 1-**
    - Install 1 Exterior Distribution Panel on backside of Restroom Building #2
    - Install exterior lighting on 3 sides of Restroom Building #2
    - Install underground service lines and 50/30/20 AMP RV Service Pedestals according to limitations above in the following locations :
      - 2 pedestals at Site 56 and Site 2
      - 1 pedestal at sites 2,3,4,30,31,32,33,35,36,37,38,39,40, and 41
    - Reclaim and reseed all disturbed areas.
  - b. **Phase 2-**
    - Install 1 Exterior Distribution Panel on backside of Restroom Building #3
    - Install exterior lighting on 3 sides of Restroom Building #3
    - Install underground service lines and 50/30/20 AMP RV Service Pedestals according to limitations above in the following locations:
      - 1 pedestal at sites 5,6,7,8,27,28,29,42,43,44,45,46,47,57
    - Reclaim and reseed all disturbed areas.
  - c. **Phase 3-**
    - Install 1 Exterior Distribution Panel on backside of Restroom Building #4
    - Install exterior lighting on 3 sides of Restroom Building #4
    - Install underground service lines and 50/30/20 AMP RV Service Pedestals according to limitations above in the following locations:
      - 1 pedestal at sites 25,26,49,50,51,52,43,54,55,56
    - Reclaim and reseed all disturbed areas.

d. **Phase 4-**

- Install 1 Exterior Distribution Panel on backside of Restroom Buildings #5 & #6
  - Install exterior lighting on 3 sides of Restroom Building #5 & #6
  - Install underground service lines and 50/30/20 AMP RV Service Pedestals according to limitations above in the following locations:
    - 1 pedestal at sites 9,10,11,12,13,14,15,16,17,18,19,20,21,22,23,24
  - Reclaim and reseed all disturbed areas
- G. Work must be scheduled and completed in 2025 after installation of main service by Wisconsin Public Service
- H. Work must be scheduled in advance according to campsite numbers in bid options, to allow for black-out of campsites during work operations. Failure to schedule in advance will result in work delays to accommodate camper reservations. Scheduling of work prior between approval of the 2025 County Budget and January 4, 2025 will result in the most flexible work options.

**Time and Place for Receiving Bids:** Langlade County will accept sealed bids from qualified firms until 12:00 p.m., Tuesday, August 27, 2024, in the office of the Langlade County Forestry, Parks, and Recreation Department, 1633 Neva Road, Antigo, Wisconsin, 54409. Bids received after 12:00 p.m. will not be accepted. Actual receipt by said time is required and deposit in the U.S. mail is insufficient. The envelope containing the sealed bid shall bear the name and address of the interested firm and the notations: "Perch Lake Campsite Pedestals" on outside of envelope. Opening of the bids will take place in the Langlade County Forestry, Parks, and Recreation Department at 3:00 following the deadline.

**Instructions:** Instructions to interested firms may be obtained from Al Murray, Forestry, Parks and Recreation Administrator, Langlade County Forestry, Parks and Recreation Department, 1633 Neva Road, Antigo, Wisconsin, 54409, (715) 627-6368 or [amurray@co.langlade.wi.us](mailto:amurray@co.langlade.wi.us).

**Reservations:** Langlade County reserves the right to reject in whole or in part any and all bids, to waive any informalities, and to accept the bids determined to be the lowest responsible bidder by the County. This invitation may be canceled if determined to be in the best interest of the County.

**Ethics:** Langlade County is an Equal Opportunity Employer. The General Code of the County of Langlade contains various purchasing policies which are applicable to this proposed procurement. These include prohibitions against gratuities and kickbacks. This request is governed by the Langlade County Purchasing Policy, a copy of which is available at the County Clerk 's office.

## INSTRUCTIONS TO BIDDERS

- I. **Bid Opening Date:** 12:00 p.m., August 27, 2024
- II. **Location:** Langlade County Forestry, Parks and Recreation Department  
1633 Neva Road, Antigo, Wisconsin, 54409
- III. Complete the Bid Form and return the entire bid package in a sealed envelope clearly marked "Bid- Perch Lake Campsite Pedestals" in the lower left corner.
- IV. The County's representative on this project is Al Murray, Forestry, Parks and Recreation Administrator. Questions regarding this project should be directed to him at the Langlade County Forestry, Parks and Recreation Department, 1633 Neva Road, Antigo, Wisconsin, 54409, (715) 627-6368 or [amurray@co.langlade.wi.us](mailto:amurray@co.langlade.wi.us).

## REQUIRED CLAUSES

### I. Gratuities and Kickbacks

It shall be unethical for any person to offer, give, or agree to give any elected official, employee or former employee, or for any elected official, employee or former employee to solicit, demand, accept, or agree to accept from another person, a gratuity or an offer for employment in connection with any decision, approval, disapproval, recommendation, preparation or any part of a program requirement or a purchase request, influencing the contents of any specification or procurement standard, rendering of advice, investigation, auditing, or in any other advisory capacity in any proceedings or application, request for ruling, determination, claim or controversy, or other particular matter, pertaining to any program requirement or a contract or subcontract, or to any solicitation or proposal therefore.

It shall be unethical for any payment, gratuity, or offer of employment to be made by or on behalf of a subcontractor under a contract to the prime contractor or a higher tier subcontractor or any person associated therewith, as an inducement for the award of a subcontract, or order.

### II. Other Required Clauses

This request for bids and the awarding of the contract must follow the procedures outlined in State Statute Section 59.52 (29) and is governed by the Purchasing Policy for Langlade County as set forth in page 69 through 71 of the Langlade County Policy Manual, a complete copy of which may be obtained from the Office of the Langlade County Clerk, Langlade County Courthouse, 800 Clermont St., Antigo, Wisconsin.

## **GENERAL CONDITIONS**

### **I. Provisions Regarding Safety, Health, and Sanitation**

- A. The Contractor shall at all times fully comply with all applicable federal, state, and local laws and regulations governing safety, health and sanitation.

The Contractor shall provide all safeguards, safety devices, and protective equipment and take any other needed actions, on his own responsibility or as the County may determine reasonably necessary to protect the life and health of employees on the job and the safety of the public, to protect property in connection with the performance of the work covered by the contract.

- B. Material Safety Data Sheets (MSDS) shall be provided to owner for all materials used in construction of this project or brought onto site. MSDS shall be provided prior to delivery of said material or substance to site.

### **II. Protection of Existing Work and Vegetation**

- A. The Contractor shall preserve and protect all existing vegetation (such as trees, shrubs, and grass), topography, and rock on or adjacent to the site which does not unreasonably interfere with the construction as may be determined by the County. The Contractor shall be responsible for all unauthorized cutting, removing, or altering of existing vegetation, topography, and rock including damage due to careless operation of equipment, stockpiling of materials, or tracking of terrain by equipment.

- B. The Contractor shall be responsible for replacing or repairing, at his/her own expense, any and all existing surface or buried structures, and electric, water, gas, telephone, and other utility lines damaged in the course of this construction project.

- C. All construction, storage, stacking, and/or parking of equipment and materials, shall be accomplished so as not to damage existing vegetation or other surface features.

### **III. Coordination of Work**

- A. Installation contractors shall visit the site prior to submitting a bid. Contractor shall identify any impediments to installation and coordinate with the Forestry, Parks and Recreation Department for removal of impediments or alternate installation procedures.

- B. The planning, scheduling, and control of the construction of this project shall be the responsibility of the Contractor.

- C. Activities shall not be scheduled to be performed in a sequence which will have detrimental effect upon other work being performed or completed. Certain activities or phases of the work shall be scheduled and coordinated by the Contractor with the Forestry, Parks and Recreation Department, or appropriate utility companies when such activities will directly affect their operations. When the Contractor's operations resulting damage to County property or to any utility, he shall assume full responsibility for such damage.
- D. Campground shall remain open during construction period. Contractor shall coordinate his work so as to minimize interference of campground activities.

#### IV. Schedule

- A. All installation activities shall be scheduled prior to January 3, 2025 to allow black-out dates for individual campsite installation if needed. To accommodate the busy camping season, all work shall occur between January 1, 2025 and May 15, 2025 or between September 8, 2025 and December 31, 2025. Time is of an essence as to completion and the Contract for the successful bidder shall have requirements for penalties for non-completion resulting from reasons within the control of the Contractor.

#### V. Insurance Requirements

- A. The Contractor shall not commence work under this contract until all insurance required under this paragraph is obtained, and such insurance has been approved by the county, nor shall Contractor allow any subcontractor to commence work on their subcontract until all similar insurance requirements have been obtained and approved.
- B. Worker's Compensation Insurance. Contractor shall obtain and maintain throughout the duration of this contract statutory Worker's Compensation insurance for all of its employees employed at the site or while working on this project. In case any work is sublet, Contractor shall require the subcontractor similarly to provide statutory Workers' Compensation Insurance for all of the latter's employees, unless such employees are covered by the protection afforded by Contractor.
- C. General Liability, Professional Liability and Property Damage Insurance. Contractor shall secure and maintain in force throughout the duration of this contract such General Liability, Professional Liability and Property Damage Insurance as shall protect him/her and any subcontractor performing work covered by this contract from claims for damages for personal injuries, including accidental death as well as from claims for property damage, which may arise from operations under this contract, whether such operations be by Contractor, or by any subcontractor or by anyone directly or indirectly employed by either of them; and the amount of such insurance shall be as follows:
- Comprehensive General Liability, \$1,000,000 per occurrence and in aggregate for Bodily Injury and Property Damage.
  - Professional Liability Coverage, \$1,000,000 per occurrence and in aggregate.
  - Automobile Liability, \$1,000,000 per occurrence and in aggregate for Bodily Injury and Property Damage.
  - Excess Liability Coverage, \$1,000,000 over the General Liability and Automobile Liability Coverages.
  - If aircraft are used in conjunction with this project, \$2,000,000 per occurrence and in aggregate for bodily injury and property damage

**D. PROOF OF INSURANCE**

Contractor shall furnish the County with a Certificate of Insurance countersigned by a Wisconsin Resident Agent or Authorized Representative of the insurer indicating that Contractor meets the insurance requirements identified above. The Certificates of Insurance shall include a provision prohibiting cancellation of said policies except upon 30 days prior written notice to the County and specify the name of the contract or project covered. A copy of the Certificate of Insurance shall be delivered to the oversight committee 15 days prior to execution of this agreement for final approval. Upon renewal of the required insurance and annually thereafter, the County shall receive a new Certificate of Insurance for three years after completion of the project. The Certificates shall describe the contract by name and or identification number in the "Description of Operations" section of the form.

**E. HOLD HARMLESS**

Contractor hereby agrees to release, indemnify, defend, and hold harmless Langlade County, their officials, officers, employees and agents from and against all judgments, damages, penalties, losses, costs, claims, expenses, suits, demands, debts, actions and/or causes of action of any type or nature whatsoever , including actual and reasonable attorney 's fees, which may be sustained or to which they may be exposed, directly or indirectly, by reason of personal injury, death, property damage, or other liability , alleged or proven, resulting from or arising out of the performance of Contractor, its officers, officials, employees, agent or assigns. Langlade County does not waive, and specifically reserves, its right to assert any and all affirmative defenses and limitations of liability as specifically set forth in Wisconsin Statutes, Chapter 893 and related statute.





# BID FORM

## PERCH LAKE CAMPSITE ELECTRIC SERVICE

After having examined the bidding and specification documents, including the INVITATION FOR BIDS, INSTRUCTIONS TO BIDDERS, REQUIRED CLAUSES, GENERAL CONDITIONS, INSURANCE REQUIREMENTS, PLANS AND TECHNICAL SPECIFICATIONS, and having understood that Langlade County reserves the right to reject any or all bids, or parts thereof, and to award to the bidder who in the judgment of the County will best serve the County; the undersigned proposes to furnish all labor, materials, and services essential to the successful completion of the contract work for the following work optio

A. **Addenda**

I/we, the bidder, acknowledge receipt of Addenda:

Number \_\_\_\_\_ dated Minimum sized services to serve only existing  
Number \_\_\_\_\_ dated \_\_\_\_\_ sites.

B. Lump Sum price to furnish, deliver and perform all work indicated on plans, specifications and details for DESIGN/BUILD OF ELECTRICAL SYSTEM TO SERVICE PERCH LAKE CAMPGROUND

a. **Phase 1-**

- Install 1 Exterior Distribution Panel on backside of Restroom Building #2
- Install exterior lighting on 3 sides of Restroom Building #2
- Install underground service lines and 50/30/20 AMP RV Service Pedestals according to limitations above in the following locations :
  - 2 pedestals at Site 56 and Site 2
  - 1 pedestal at sites 2,3,4,30,31,32,33,35,36,37,38,39,40, and 41
- Reclaim and reseed all disturbed areas.

**TOTAL COST FOR COMPLETION OF PHASE 1 ONLY:**

\$ 67,500.00

**b. Phase 2-**

- Install 1 Exterior Distribution Panel on backside of Restroom Building #3
- Install exterior lighting on 3 sides of Restroom Building #3
- Install underground service lines and 50/30/20 AMP RV Service Pedestals according to limitations above in the following locations:
  - 1 pedestal at sites 5,6,7,8,27,28,29,42,43,44,45,46,47,57
- Reclaim and reseed all disturbed areas.

**TOTAL COST FOR COMPLETION OF PHASE 2 ONLY:**

\$ 54,200.<sup>00</sup>

**c. Phase 3-**

- Install 1 Exterior Distribution Panel on backside of Restroom Building #4
- Install exterior lighting on 3 sides of Restroom Building #4
- Install underground service lines and 50/30/20 AMP RV Service Pedestals according to limitations above in the following locations:
  - 1 pedestal at sites 25,26,49,50,51,52,43,54,55,56
- Reclaim and reseed all disturbed areas.

**TOTAL COST FOR COMPLETION OF PHASE 3 ONLY:**

\$ 39,700.<sup>00</sup>

**d. Phase 4-**

- Install 1 Exterior Distribution Panel on backside of Restroom Buildings #5 & #6
- Install exterior lighting on 3 sides of Restroom Building #5 & #6
- Install underground service lines and 50/30/20 AMP RV Service Pedestals according to limitations above in the following locations:
  - 1 pedestal at sites 9,10,11,12,13,14,15,16,17,18,19,20,21,22,23,24
- Reclaim and reseed all disturbed areas

**TOTAL COST FOR COMPLETION OF PHASE 4 ONLY:**

\$ 61,700.<sup>00</sup>

**TOTAL COST FOR COMPLETION PHASES 1, 2, 3& 4) CONCURRENTLY:**

\$ 212,000.<sup>00</sup>

C. **Certification**

I/we understand this bid is good for ninety (90) days and if accepted by the County will be used as the basis for a contract for the work covered within the bidding documents and specifications and the contract documents.

Company: Andraschko Plumbing + Electric LLC.  
(type or Print)

Company Address: W9742 Hoyt Rd. Birnamwood WI  
(type or Print)

Phone: 715-610-2040  
(type or Print)

E-mail: tomandraschko@gmail.com

Name/Title: Tom Andraschko Owner  
(type or Print)

Authorized Signature: Tom Andraschko  
(Signature)



# BID FORM

## PERCH LAKE CAMPSITE ELECTRIC SERVICE

After having examined the bidding and specification documents, including the INVITATION FOR BIDS, INSTRUCTIONS TO BIDDERS, REQUIRED CLAUSES, GENERAL CONDITIONS, INSURANCE REQUIREMENTS, PLANS AND TECHNICAL SPECIFICATIONS, and having understood that Langlade County reserves the right to reject any or all bids, or parts thereof, and to award to the bidder who in the judgment of the County will best serve the County; the undersigned proposes to furnish all labor, materials, and services essential to the successful completion of the contract work for the following work optio

A. **Addenda**

I/we, the bidder, acknowledge receipt of Addenda:

Number \_\_\_\_\_ dated N/A

Number \_\_\_\_\_ dated N/A

B. Lump Sum price to furnish, deliver and perform all work indicated on plans, specifications and details for DESIGN/BUILD OF ELECTRICAL SYSTEM TO SERVICE PERCH LAKE CAMPGROUND

a. **Phase 1-**

- Install 1 Exterior Distribution Panel on backside of Restroom Building #2
- Install exterior lighting on 3 sides of Restroom Building #2
- Install underground service lines and 50/30/20 AMP RV Service Pedestals according to limitations above in the following locations :
  - 2 pedestals at Site 56 and Site 2
  - 1 pedestal at sites 2,3,4,30,31,32,33,35,36,37,38,39,40, and 41
- Reclaim and reseed all disturbed areas.

**TOTAL COST FOR COMPLETION OF PHASE 1 ONLY:**

\$ 81,858.44 + \$4,623.56

*800 amp service*

**b. Phase 2-**

- Install 1 Exterior Distribution Panel on backside of Restroom Building #3
- Install exterior lighting on 3 sides of Restroom Building #3
- Install underground service lines and 50/30/20 AMP RV Service Pedestals according to limitations above in the following locations:
  - 1 pedestal at sites 5,6,7,8,27,28,29,42,43,44,45,46,47,57
- Reclaim and reseed all disturbed areas.

**TOTAL COST FOR COMPLETION OF PHASE 2 ONLY:**

\$53,218.75 + \$3,280.46

**c. Phase 3-**

- Install 1 Exterior Distribution Panel on backside of Restroom Building #4
- Install exterior lighting on 3 sides of Restroom Building #4
- Install underground service lines and 50/30/20 AMP RV Service Pedestals according to limitations above in the following locations:
  - 1 pedestal at sites 25,26,49,50,51,52,43,54,55,56
- Reclaim and reseed all disturbed areas.

**TOTAL COST FOR COMPLETION OF PHASE 3 ONLY:**

\$41,211.26 + \$6,511.82

**d. Phase 4-**

- Install 1 Exterior Distribution Panel on backside of Restroom Buildings #5 & #6
- Install exterior lighting on 3 sides of Restroom Building #5 & #6
- Install underground service lines and 50/30/20 AMP RV Service Pedestals according to limitations above in the following locations:
  - 1 pedestal at sites 9,10,11,12,13,14,15,16,17,18,19,20,21,22,23,24
- Reclaim and reseed all disturbed areas

**TOTAL COST FOR COMPLETION OF PHASE 4 ONLY:**

\$61,974.93 + \$10,289.18

**TOTAL COST FOR COMPLETION PHASES 1, 2, 3& 4) CONCURRENTLY:**

\$238,263.38 + \$24,705.02

C. **Certification**

I/we understand this bid is good for ninety (90) days and if accepted by the County will be used as the basis for a contract for the work covered within the bidding documents and specifications and the contract documents.

Company: Pieper Electric Inc  
(type or Print)

Company Address: W4618 County Road G Merrill WI 54452  
(type or Print)

Phone: 715-297-1070  
(type or Print)

E-mail: trent.vollrath@pieperpower.com

Name/Title: Trent Vollrath Department Manager  
(type or Print)

Authorized Signature: Trent Vollrath  
(Signature)

Digitally signed by Trent Vollrath  
DN: cn=Trent Vollrath, o=Pieper Electric, c=US  
Date: 2024.03.27 11:02:37 -0500





LANGLADE COUNTY  
FORESTRY, PARKS, AND  
RECREATION DEPARTMENT  
1633 NEVA ROAD  
ANTIGO, WISCONSIN 54409



BID SPECIFICATIONS, BID FORMS  
AND RELATED DOCUMENTS FOR  
**PERCH LAKE CAMPSITE ELECTRIC SERVICE**

AUGUST 8, 2024

\* 800 amp at all service locations



**TABLE OF CONTENTS**

**PAGE**

---

INVITATION FOR BIDS.....1  
INSTRUCTIONS TO BIDDERS.....3  
REQUIRED CLAUSES.....3  
GENERAL CONDITIONS.....3  
INSURANCE REQUIREMENTS.....4  
HOLD HARMLESS.....5  
BID FORM.....6

**INVITATION FOR BIDS FOR  
PERCH LAKE CAMPSITE ELECTRIC SERVICE**

**Purpose:** Langlade County is soliciting bids from electrical companies to design and build an electrical service system to service the newly built Perch Lake Campground located at N10571 Clear Lake Rd, Elcho, WI 54428

- A. Contracting company shall design, engineer and install electrical system capable of properly servicing 50/30/20 AMP RV pedestal sites at campsites from Wisconsin Public Service locations to pedestal sites. WPS service will be no more than 15 feet from existing restroom buildings.
- B. To protect campground users that may pound stakes electrical service lines shall not be more than 3 feet from existing gravel roadways or established camping pad
- C. Pedestal locations shall be on the righthand side of camping pad as looking from the roadway and shall be no more than 10 feet from the rear of the established camping pad.
- D. Design shall include installation of exterior service panels to be located on the back side of existing restroom buildings.
- E. Design shall also include installation of exterior lighting on three sides of the exiting restroom building where the distribution panel is installed.
- F. Work will be bid as 4 phases with the County decision on any or all of the phases dependent upon County approval of WPS service locations.
  - a. **Phase 1-**
    - Install 1 Exterior Distribution Panel on backside of Restroom Building #2
    - Install exterior lighting on 3 sides of Restroom Building #2
    - Install underground service lines and 50/30/20 AMP RV Service Pedestals according to limitations above in the following locations :
      - 2 pedestals at Site 56 and Site 2
      - 1 pedestal at sites 2,3,4,30,31,32,33,35,36,37,38,39,40, and 41
    - Reclaim and reseed all disturbed areas.
  - b. **Phase 2-**
    - Install 1 Exterior Distribution Panel on backside of Restroom Building #3
    - Install exterior lighting on 3 sides of Restroom Building #3
    - Install underground service lines and 50/30/20 AMP RV Service Pedestals according to limitations above in the following locations:
      - 1 pedestal at sites 5,6,7,8,27,28,29,42,43,44,45,46,47,57
    - Reclaim and reseed all disturbed areas.
  - c. **Phase 3-**
    - Install 1 Exterior Distribution Panel on backside of Restroom Building #4
    - Install exterior lighting on 3 sides of Restroom Building #4
    - Install underground service lines and 50/30/20 AMP RV Service Pedestals according to limitations above in the following locations:
      - 1 pedestal at sites 25,26,49,50,51,52,43,54,55,56
    - Reclaim and reseed all disturbed areas.

**d. Phase 4-**

- Install 1 Exterior Distribution Panel on backside of Restroom Buildings #5 & #6
  - Install exterior lighting on 3 sides of Restroom Building #5 & #6
  - Install underground service lines and 50/30/20 AMP RV Service Pedestals according to limitations above in the following locations:
    - 1 pedestal at sites 9,10,11,12,13,14,15,16,17,18,19,20,21,22,23,24
  - Reclaim and reseed all disturbed areas
- G. Work must be scheduled and completed in 2025 after installation of main service by Wisconsin Public Service
- H. Work must be scheduled in advance according to campsite numbers in bid options, to allow for black-out of campsites during work operations. Failure to schedule in advance will result in work delays to accommodate camper reservations. Scheduling of work prior between approval of the 2025 County Budget and January 4, 2025 will result in the most flexible work options.

**Time and Place for Receiving Bids:** Langlade County will accept sealed bids from qualified firms until 12:00 p.m., Tuesday, August 27, 2024, in the office of the Langlade County Forestry, Parks, and Recreation Department, 1633 Neva Road, Antigo, Wisconsin, 54409. Bids received after 12:00 p.m. will not be accepted. Actual receipt by said time is required and deposit in the U.S. mail is insufficient. The envelope containing the sealed bid shall bear the name and address of the interested firm and the notations: "Perch Lake Campsite Pedestals" on outside of envelope. Opening of the bids will take place in the Langlade County Forestry, Parks, and Recreation Department at 3:00 following the deadline.

**Instructions:** Instructions to interested firms may be obtained from Al Murray, Forestry, Parks and Recreation Administrator, Langlade County Forestry, Parks and Recreation Department, 1633 Neva Road, Antigo, Wisconsin, 54409, (715) 627-6368 or [amurray@co.langlade.wi.us](mailto:amurray@co.langlade.wi.us).

**Reservations:** Langlade County reserves the right to reject in whole or in part any and all bids, to waive any informalities, and to accept the bids determined to be the lowest responsible bidder by the County. This invitation may be canceled if determined to be in the best interest of the County.

**Ethics:** Langlade County is an Equal Opportunity Employer. The General Code of the County of Langlade contains various purchasing policies which are applicable to this proposed procurement. These include prohibitions against gratuities and kickbacks. This request is governed by the Langlade County Purchasing Policy, a copy of which is available at the County Clerk's office.

## INSTRUCTIONS TO BIDDERS

- I. **Bid Opening Date:** 12:00 p.m., August 27, 2024
- II. **Location:** Langlade County Forestry, Parks and Recreation Department  
1633 Neva Road, Antigo, Wisconsin, 54409
- III. Complete the Bid Form and return the entire bid package in a sealed envelope clearly marked **"Bid- Perch Lake Campsite Pedestals"** in the lower left corner.
- IV. The County's representative on this project is Al Murray, Forestry, Parks and Recreation Administrator. Questions regarding this project should be directed to him at the Langlade County Forestry, Parks and Recreation Department, 1633 Neva Road, Antigo, Wisconsin, 54409, (715) 627-6368 or [amurray@co.langlade.wi.us](mailto:amurray@co.langlade.wi.us).

## REQUIRED CLAUSES

### I. Gratuities and Kickbacks

It shall be unethical for any person to offer, give, or agree to give any elected official, employee or former employee, or for any elected official, employee or former employee to solicit, demand, accept, or agree to accept from another person, a gratuity or an offer for employment in connection with any decision, approval, disapproval, recommendation, preparation or any part of a program requirement or a purchase request, influencing the contents of any specification or procurement standard, rendering of advice, investigation, auditing, or in any other advisory capacity in any proceedings or application, request for ruling, determination, claim or controversy, or other particular matter, pertaining to any program requirement or a contract or subcontract, or to any solicitation or proposal therefore.

It shall be unethical for any payment, gratuity, or offer of employment to be made by or on behalf of a subcontractor under a contract to the prime contractor or a higher tier subcontractor or any person associated therewith, as an inducement for the award of a subcontract, or order.

### II. Other Required Clauses

This request for bids and the awarding of the contract must follow the procedures outlined in State Statute Section 59.52 (29) and is governed by the Purchasing Policy for Langlade County as set forth in page 69 through 71 of the Langlade County Policy Manual, a complete copy of which may be obtained from the Office of the Langlade County Clerk, Langlade County Courthouse, 800 Clermont St., Antigo, Wisconsin.

## **GENERAL CONDITIONS**

### **I. Provisions Regarding Safety, Health, and Sanitation**

- A. The Contractor shall at all times fully comply with all applicable federal, state, and local laws and regulations governing safety, health and sanitation.

The Contractor shall provide all safeguards, safety devices, and protective equipment and take any other needed actions, on his own responsibility or as the County may determine reasonably necessary to protect the life and health of employees on the job and the safety of the public, to protect property in connection with the performance of the work covered by the contract.

- B. Material Safety Data Sheets (MSDS) shall be provided to owner for all materials used in construction of this project or brought onto site. MSDS shall be provided prior to delivery of said material or substance to site.

### **II. Protection of Existing Work and Vegetation**

- A. The Contractor shall preserve and protect all existing vegetation (such as trees, shrubs, and grass), topography, and rock on or adjacent to the site which does not unreasonably interfere with the construction as may be determined by the County. The Contractor shall be responsible for all unauthorized cutting, removing, or altering of existing vegetation, topography, and rock including damage due to careless operation of equipment, stockpiling of materials, or tracking of terrain by equipment.
- B. The Contractor shall be responsible for replacing or repairing, at his/her own expense, any and all existing surface or buried structures, and electric, water, gas, telephone, and other utility lines damaged in the course of this construction project.
- C. All construction, storage, stacking, and/or parking of equipment and materials, shall be accomplished so as not to damage existing vegetation or other surface features.

### **III. Coordination of Work**

- A. Installation contractors shall visit the site prior to submitting a bid. Contractor shall identify any impediments to installation and coordinate with the Forestry, Parks and Recreation Department for removal of impediments or alternate installation procedures.
- B. The planning, scheduling, and control of the construction of this project shall be the responsibility of the Contractor.

- C. Activities shall not be scheduled to be performed in a sequence which will have detrimental effect upon other work being performed or completed. Certain activities or phases of the work shall be scheduled and coordinated by the Contractor with the Forestry, Parks and Recreation Department, or appropriate utility companies when such activities will directly affect their operations. When the Contractor's operations resulting damage to County property or to any utility, he shall assume full responsibility for such damage.
- D. Campground shall remain open during construction period. Contractor shall coordinate his work so as to minimize interference of campground activities.

#### IV. Schedule

- A. All installation activities shall be scheduled prior to January 3, 2025 to allow black-out dates for individual campsite installation if needed. To accommodate the busy camping season, all work shall occur between January 1, 2025 and May 15, 2025 or between September 8, 2025 and December 31, 2025. Time is of an essence as to completion and the Contract for the successful bidder shall have requirements for penalties for non-completion resulting from reasons within the control of the Contractor.

#### V. Insurance Requirements

- A. The Contractor shall not commence work under this contract until all insurance required under this paragraph is obtained, and such insurance has been approved by the county, nor shall Contractor allow any subcontractor to commence work on their subcontract until all similar insurance requirements have been obtained and approved.
- B. Worker's Compensation Insurance. Contractor shall obtain and maintain throughout the duration of this contract statutory Worker's Compensation insurance for all if its employees employed at the site or while working on this project. In case any work is sublet, Contractor shall require the subcontractor similarly to provide statutory Workers' Compensation Insurance for all of the latter's employees, unless such employees are covered by the protection afforded by Contractor.
- C. General Liability, Professional Liability and Property Damage Insurance. Contractor shall secure and maintain in force throughout the duration of this contract such General Liability, Professional Liability and Property Damage Insurance as shall protect him/her and any subcontractor performing work covered by this contract from claims for damages for personal injuries, including accidental death as well as from claims for property damage, which may arise from operations under this contract, whether such operations be by Contractor, or by any subcontractor or by anyone directly or indirectly employed by either of them; and the amount of such insurance shall be as follows:
- Comprehensive General Liability, \$1,000,000 per occurrence and in aggregate for Bodily Injury and Property Damage.
  - Professional Liability Coverage, \$1,000,000 per occurrence and in aggregate.
  - Automobile Liability, \$1,000,000 per occurrence and in aggregate for Bodily Injury and Property Damage.
  - Excess Liability Coverage, \$1,000,000 over the General Liability and Automobile Liability Coverages.
  - If aircraft are used in conjunction with this project, \$2,000,000 per occurrence and in aggregate for bodily injury and property damage



**D. PROOF OF INSURANCE**

Contractor shall furnish the County with a Certificate of Insurance countersigned by a Wisconsin Resident Agent or Authorized Representative of the insurer indicating that Contractor meets the insurance requirements identified above. The Certificates of Insurance shall include a provision prohibiting cancellation of said policies except upon 30 days prior written notice to the County and specify the name of the contract or project covered. A copy of the Certificate of Insurance shall be delivered to the oversight committee 15 days prior to execution of this agreement for final approval. Upon renewal of the required insurance and annually thereafter, the County shall receive a new Certificate of Insurance for three years after completion of the project. The Certificates shall describe the contract by name and or identification number in the "Description of Operations" section of the form.

**E. HOLD HARMLESS**

Contractor hereby agrees to release, indemnify, defend, and hold harmless Langlade County, their officials, officers, employees and agents from and against all judgments, damages, penalties, losses, costs, claims, expenses, suits, demands, debts, actions and/or causes of action of any type or nature whatsoever , including actual and reasonable attorney 's fees, which may be sustained or to which they may be exposed, directly or indirectly, by reason of personal injury, death, property damage, or other liability , alleged or proven, resulting from or arising out of the performance of Contractor, its officers, officials, employees, agent or assigns. Langlade County does not waive, and specifically reserves, its right to assert any and all affirmative defenses and limitations of liability as specifically set forth in Wisconsin Statutes, Chapter 893 and related statute.



# BID FORM

## PERCH LAKE CAMPSITE ELECTRIC SERVICE

After having examined the bidding and specification documents, including the INVITATION FOR BIDS, INSTRUCTIONS TO BIDDERS, REQUIRED CLAUSES, GENERAL CONDITIONS, INSURANCE REQUIREMENTS, PLANS AND TECHNICAL SPECIFICATIONS, and having understood that Langlade County reserves the right to reject any or all bids, or parts thereof, and to award to the bidder who in the judgment of the County will best serve the County; the undersigned proposes to furnish all labor, materials, and services essential to the successful completion of the contract work for the following work optio

**A. Addenda**

I/we, the bidder, acknowledge receipt of Addenda:

Number \_\_\_\_\_ dated (Emailed 8-24-24) \* 800 amp at all service  
Number \_\_\_\_\_ dated \_\_\_\_\_ locations.

**B. Lump Sum price to furnish, deliver and perform all work indicated on plans, specifications and details for DESIGN/BUILD OF ELECTRICAL SYSTEM TO SERVICE PERCH LAKE CAMPGROUND**

**a. Phase 1-**

- Install 1 Exterior Distribution Panel on backside of Restroom Building #2
- Install exterior lighting on 3 sides of Restroom Building #2
- Install underground service lines and 50/30/20 AMP RV Service Pedestals according to limitations above in the following locations :
  - 2 pedestals at Site 56 and Site 2
  - 1 pedestal at sites 2,3,4,30,31,32,33,35,36,37,38,39,40, and 41
- Reclaim and reseed all disturbed areas.

**TOTAL COST FOR COMPLETION OF PHASE 1 ONLY:**

\$ 68,650.00

**b. Phase 2-**

- Install 1 Exterior Distribution Panel on backside of Restroom Building #3
- Install exterior lighting on 3 sides of Restroom Building #3
- Install underground service lines and 50/30/20 AMP RV Service Pedestals according to limitations above in the following locations:
  - 1 pedestal at sites 5,6,7,8,27,28,29,42,43,44,45,46,47,57
- Reclaim and reseed all disturbed areas.

**TOTAL COST FOR COMPLETION OF PHASE 2 ONLY:**

\$ 55,200.00

**c. Phase 3-**

- Install 1 Exterior Distribution Panel on backside of Restroom Building #4
- Install exterior lighting on 3 sides of Restroom Building #4
- Install underground service lines and 50/30/20 AMP RV Service Pedestals according to limitations above in the following locations:
  - 1 pedestal at sites 25,26,49,50,51,52,43,54,55,56
- Reclaim and reseed all disturbed areas.

**TOTAL COST FOR COMPLETION OF PHASE 3 ONLY:**

\$ 49,850.00

**d. Phase 4-**

- Install 1 Exterior Distribution Panel on backside of Restroom Buildings #5 & #6
- Install exterior lighting on 3 sides of Restroom Building #5 & #6
- Install underground service lines and 50/30/20 AMP RV Service Pedestals according to limitations above in the following locations:
  - 1 pedestal at sites 9,10,11,12,13,14,15,16,17,18,19,20,21,22,23,24
- Reclaim and reseed all disturbed areas

**TOTAL COST FOR COMPLETION OF PHASE 4 ONLY:**

\$ 82,500.00

**TOTAL COST FOR COMPLETION PHASES 1, 2, 3& 4) CONCURRENTLY:**

\$ 245,000.00

**b. Phase 2-**

- Install 1 Exterior Distribution Panel on backside of Restroom Building #3
- Install exterior lighting on 3 sides of Restroom Building #3
- Install underground service lines and 50/30/20 AMP RV Service Pedestals according to limitations above in the following locations:
  - 1 pedestal at sites 5,6,7,8,27,28,29,42,43,44,45,46,47,57
- Reclaim and reseed all disturbed areas.

**TOTAL COST FOR COMPLETION OF PHASE 2 ONLY:**

\$ 55,700.<sup>00</sup>

**c. Phase 3-**

- Install 1 Exterior Distribution Panel on backside of Restroom Building #4
- Install exterior lighting on 3 sides of Restroom Building #4
- Install underground service lines and 50/30/20 AMP RV Service Pedestals according to limitations above in the following locations:
  - 1 pedestal at sites 25,26,49,50,51,52,43,54,55,56
- Reclaim and reseed all disturbed areas.

**TOTAL COST FOR COMPLETION OF PHASE 3 ONLY:**

\$ 50,350.<sup>00</sup>

**d. Phase 4-**

- Install 1 Exterior Distribution Panel on backside of Restroom Buildings #5 & #6
- Install exterior lighting on 3 sides of Restroom Building #5 & #6
- Install underground service lines and 50/30/20 AMP RV Service Pedestals according to limitations above in the following locations:
  - 1 pedestal at sites 9,10,11,12,13,14,15,16,17,18,19,20,21,22,23,24
- Reclaim and reseed all disturbed areas

**TOTAL COST FOR COMPLETION OF PHASE 4 ONLY:**

\$ 83,000

**TOTAL COST FOR COMPLETION PHASES 1, 2, 3 & 4) CONCURRENTLY:**

\$ 247,500.<sup>00</sup>

# BID FORM

## PERCH LAKE CAMPSITE ELECTRIC SERVICE

After having examined the bidding and specification documents, including the INVITATION FOR BIDS, INSTRUCTIONS TO BIDDERS, REQUIRED CLAUSES, GENERAL CONDITIONS, INSURANCE REQUIREMENTS, PLANS AND TECHNICAL SPECIFICATIONS, and having understood that Langlade County reserves the right to reject any or all bids, or parts thereof, and to award to the bidder who in the judgment of the County will best serve the County; the undersigned proposes to furnish all labor, materials, and services essential to the successful completion of the contract work for the following work optio

**A. Addenda**

I/we, the bidder, acknowledge receipt of Addenda:

Number \_\_\_\_\_ dated 800 amp services at all locations  
Number \_\_\_\_\_ dated 8-24-24- Al Murray

**B. Lump Sum price to furnish, deliver and perform all work indicated on plans, specifications and details for DESIGN/BUILD OF ELECTRICAL SYSTEM TO SERVICE PERCH LAKE CAMPGROUND**

**a. Phase 1-**

- Install 1 Exterior Distribution Panel on backside of Restroom Building #2
- Install exterior lighting on 3 sides of Restroom Building #2
- Install underground service lines and 50/30/20 AMP RV Service Pedestals according to limitations above in the following locations :
  - 2 pedestals at Site 56 and Site 2
  - 1 pedestal at sites 2,3,4,30,31,32,33,35,36,37,38,39,40, and 41
- Reclaim and reseed all disturbed areas.

**TOTAL COST FOR COMPLETION OF PHASE 1 ONLY:**

\$ 69,150.00

C. **Certification**

I/we understand this bid is good for ninety (90) days and if accepted by the County will be used as the basis for a contract for the work covered within the bidding documents and specifications and the contract documents.

Company: Andraschko Plumbing & Electric LLC  
(type or Print)

Company Address: W9742 Hoyt Rd. Birnamwood WI  
(type or Print)

Phone: 715-610-2040  
(type or Print)

E-mail: tomandraschko@gmail.com

Name/Title: Tom Andraschko Owner  
(type or Print)

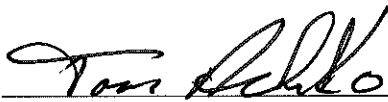
Authorized Signature:   
(Signature)

**Perch Lake Campsite Pedestals  
N10571 Clear Lake Road  
Elcho, Wisconsin 54481**

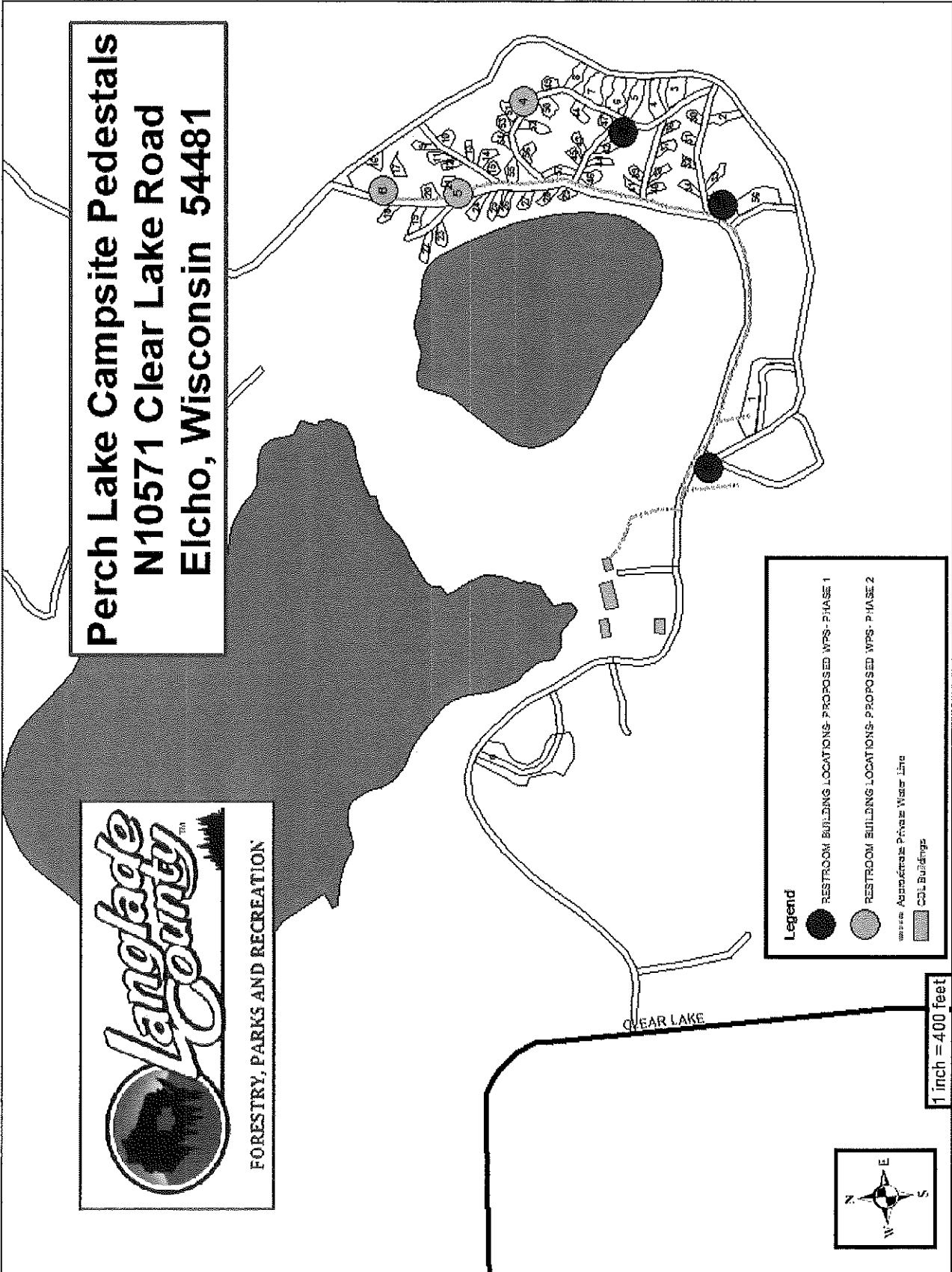
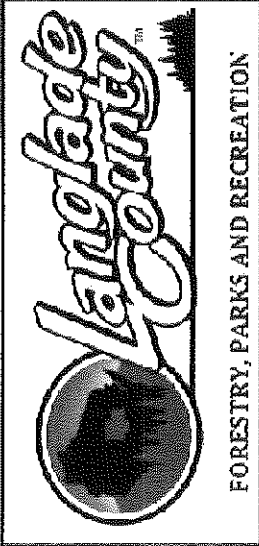

**Legend**

- RESTROOM BUILDING LOCATIONS- PROPOSED WPS- PHASE 1
- RESTROOM BUILDING LOCATIONS- PROPOSED WPS- PHASE 2
- Associate Private Water Line
- ▭ CGL Buildings

1 inch = 400 feet

