



Langlade County Forestry, Recreation & Parks Department  
1633 Neva Rd  
Antigo, WI 54409  
Phone 715-627-6300 Fax 715-627-6276

October 27, 2025

To: Langlade County Logging Contractors

From: Al Murray  
Forest Administrator

Subject: Langlade County Pulp and Timber Sales – December 3, 2025

Attached are the timber sale maps for the Fall of 2025. Sale maps will also be available on Langlade County and DNR websites. Also, please note that there are different minimum bids for each species by product.

The estimates on all sales are for the purpose of bidding and are offered as a guide to the amount of timber to be found on each job. All payments are based on actual scale. If you have any questions regarding the jobs or volume estimates, feel free to contact our office at 627-6300.

The Langlade County Forestry & Recreation Committee would like to remind all interested loggers submitting bids for the 2025 Fall timber sales that **you are required to show that loggers are FISTA trained and up to date throughout the term of the contract.** If you are the successful bidder on a timber sale, your certification must remain current until the timber sale has been completed.

Bids must be accompanied by 10% of bid price payable to the Langlade County Treasurer. **An additional 15% will be required upon sale start-up.** The initial 10% due at time of bidding will be considered the performance bond for the timber sale and will be held by the county until the sale is completed and all stumpage charges are satisfied. The additional 15% will not be required until the logger is ready to begin cutting the sale and will then be used as the prepayment for stumpage. If a logger starts the sale before the forestry department receives the additional 15%, the old policy of the additional 15% being due within 15 days of the letting of the sale will be re-instituted for that logger.

Bids must be by ton or MBF as offered. **Please note that some sales have comingled products with a single per ton price for basswood pulp and sawlogs.** Please submit your sealed bids to the Forestry and Recreation Office, 1633 Neva Road, Antigo, WI 54409 no later than 8:45 a.m. on December 3, 2025. All bids will be opened at 9:00 a.m. on December 3, 2025, in the Conference Room, Forestry, Parks & Recreation Building, Langlade County Fairgrounds, Antigo.

Bids **MUST BE ON STANDARD BID FORM, FOR THE CORRECT SALE, AS ATTACHED TO THIS LETTER.** Additional packets are available at the office upon request. If there is anyone who is not familiar with our timber sale policy; be sure to review it before submitting a bid.

**Special Note: Sales #8 or #13 offer a whole tree bidding option, bid forms must utilize the whole tree option to utilize biomass less than 5". If completed bid form utilizes the 5" top option on sales #8 or #13, biomass cannot be utilized.**

Requirement for timber sales in 2025 will require successful bidders to complete a Sales Tax Exemption form for products purchased. A form S-211 will be required for each timber sale purchased prior to any sale activity.





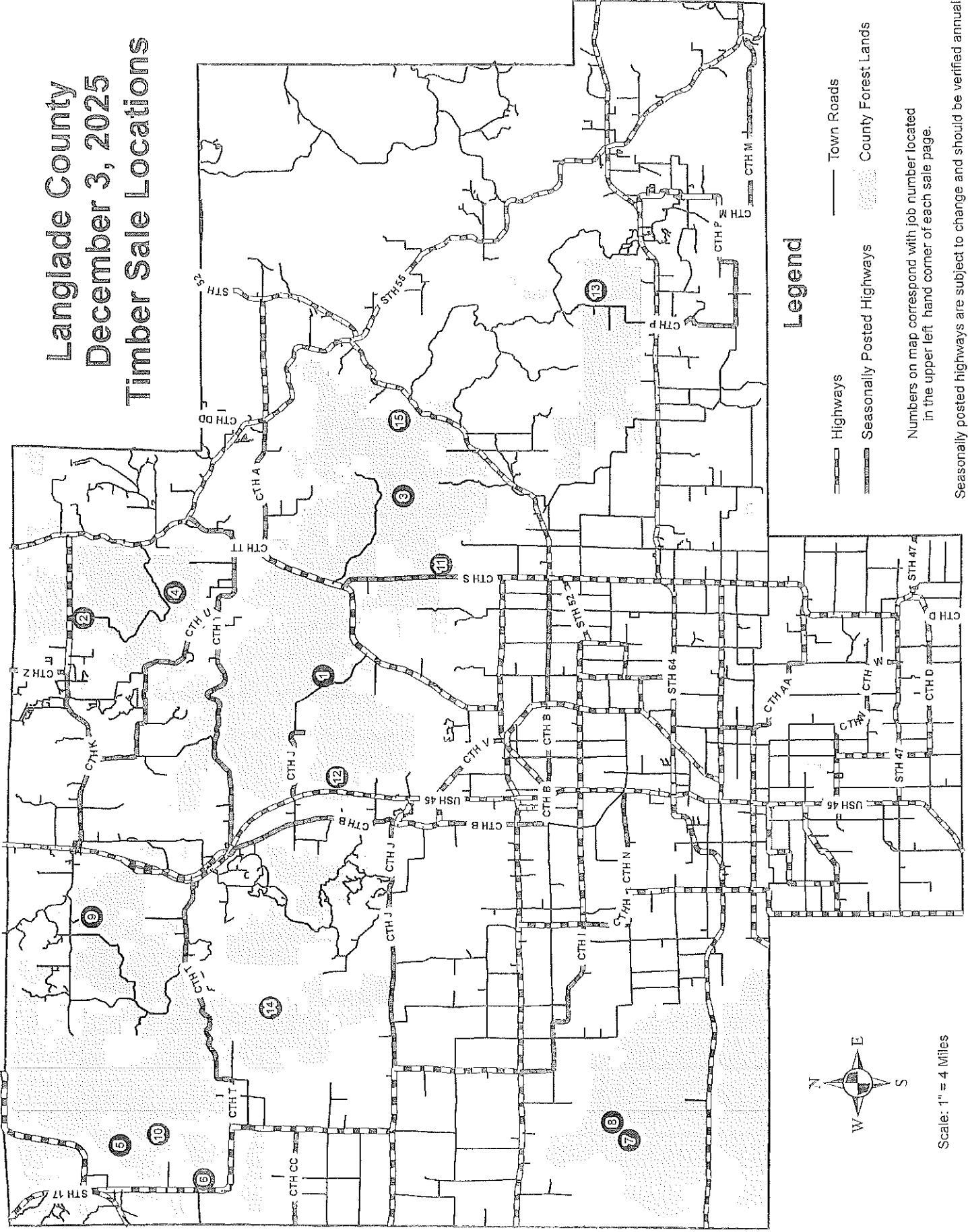

## BASIC SUMMARY OF TIMBER SALE REGULATIONS AND BIDDING

- 1) **Timber Sales are subject to all regulations within the new timber sale contract.** It is recommended that bidders review the sample timber sale contract before bidding.
- 2) The Seller requires logger qualification to determine methods of accounting for products sold. Qualification requires provision of information, including past references and action history, from the Purchaser to adequately assess and demonstrate the ability of the Purchaser to successfully follow requirements for the Mill Scale System and meet payment requirements of that system. Logger history will determine if or when mill scale will be accepted. Unless mill scale, use has been approved as a mill scale qualified contractor, no forest products shall be removed until scaled and marked by the county scaler unless other arrangements are made and approved by the Forest Administrator. **Wood shipped to buyers without scalers (firewood, unmanned landings, private wood yards) require woods scale by the County, unless otherwise approved by the Forest Administrator. Woods scaling requires a minimum 24-hour notice and will only be completed from 7:00 a.m. until 3:00 p.m. on Monday through Friday with no scaling on County observed Holidays.**
- 3) Cut wood products will be utilized to a minimum specification of a 100-inch stick with a minimum four-inch top diameter inside the bark.
- 4) Tracts or designated species purchased as whole tree volume must utilize the whole tree.
- 5) Maximum stump height shall not exceed the diameter of the stump or 12 inches from the ground, whichever is less. Violations of the maximum stump height limitations will be documented on the Timber Sale Inspection form when observed followed by a verbal warning. Second observations of the maximum stump height will be documented on the timber sale inspection form with written notice of violation provided by the Seller's representative to the Purchaser within 7 days of violation. Any further violation of stump height regulations following a written warning will result in a **penalty of up to \$5 per stump** assessed.
- 6) The **Purchaser shall ensure the corresponding mill tickets to match the haul permits are delivered** to the Seller within 30-days following shipping of product. The County shall provide written notice to the Purchaser of all shipments that have not been accounted for at the end of 30 days. Failure by the Purchaser to provide mill scale slips missing within 15 days after the 30-day written notice, will result in load charges as follows: 50 ton per load for weight scaled product, 20 cords for stick scaled cordwood products, 8000 board feet for stick scaled sawlog products.
- 7) All wood not paid for at the specified stumpage rate remains the property of Langlade County. This includes tops smaller than the utilization specification for cordwood products. Contractors removing firewood must obtain and are subject to terms of a firewood permit.
- 8) Piling of forest products on public road right-of-way must be approved by Town Chairman. The forestry department will provide contact information for the proper Town representative.
- 9) Purchaser shall be liable for unwarranted site damage as a result of his operations and shall comply with all laws regarding stream crossings.
- 10) Any access across private lands or other lands not owned and operated by Langlade County is the responsibility of the Purchaser.
- 11) Timber sales contracts cannot be assigned in part or whole without written approval by the administrator.
- 12) The purchaser is an independent contractor and not an employee or agent of the County.
- 13) Only bids submitted that meet or exceed the minimum advertised stumpage rate for each species and product listed for a particular job will be considered for acceptance.
- 14) In the event that a bid is submitted that does not meet the minimum advertised stumpage rate for each species and product for a particular job, the County reserves the right to choose the bid most advantageous to the county.
- 15) Any or all bids may be rejected by assigned representatives of the County.
- 16) All sealed bids are to be plainly marked on the outside of the envelope: Timber Sale Bid - Job No. \_\_\_\_
- 17) All saw logs must be separated from pulpwood then piled for inspection to ensure conformance with contract diameter utilization standards. Minimum diameter for saw logs is 10" inside the bark and meeting grade 3 of the Timber Professionals Association grading guidelines.
- 18) The purchaser shall provide the county a minimum of a three-day notice and provide all documents required in the Contract prior to any performance under the contract.
- 19) The timber sale bid form, upon signing, will become part of the timber sale contract.
- 20) The actual logging contractor is required to comply with the Sustainable Forestry Initiative (SFI) Training Standard.
- 21) Logging contractor will follow Best Management Practices (B.M.P.'s) during all phases of timber sale.
- 22) Biomass Policy – Top wood (Wood less than 4") – if utilized, will be charged at a rate of \$1.00/ton unless otherwise detailed in the timber sale contract. **\$1.00 per ton biomass not available on Sales #8 or #13 due to whole tree bidding option**
- 23) All equipment on timber sale site must be clean and inspected before entering and starting the sale. Please call the Forestry office if you need assistance with cleaning equipment or would like an inspection. (715-627-6300)

# Langlade County December 3, 2025 Timber Sale Locations



## Legend

-  Highways
-  Seasonally Posted Highways
-  Town Roads
-  County Forest Lands

Numbers on map correspond with job number located in the upper left hand corner of each sale page.

Seasonally posted highways are subject to change and should be verified annually.

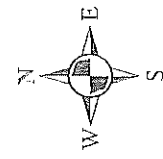

Scale: 1" = 4 Miles

Langlade County Pulp and Timber Sale  
December 3, 2025

Job # 1

Location: Township of Upham (east): Compartments 112, 113 & 115  
SESE Section 23, SWSW Section 24, NW1/4, NWSW Section 25, NE1/4, Section 26 T33N R11E  
45.317454, -89.070425

Cutting Area: 105 Acres

Product/Species		Estimated Unit Volume		Minimum Bid Per Unit	Estimated Value	Bid Per Unit	Total
Aspen Pulp	Tons	2,895	(1,257 cds)	\$9.00	\$26,055.00		
Mixed Hardwood Pulp	Tons	625	(260 cds)	\$7.70	\$4,812.50		
Basswood Pulp	Tons	125	(62 cds)	\$2.00	\$250.00		
Balsam Fir Pulp	Tons	95	(41 cds)	\$2.60	\$247.00		
Red Oak Pulp	Tons	95	(38cds)	\$7.40	\$703.00		
Red Pine Pulp/Logs	Tons	55	(24 cds)	\$27.20	\$1,496.00		
White Pine Pulp/Logs	Tons	25	(10 cds)	\$5.90	\$147.50		
Red Oak Logs	MBF	22		\$327.00	\$7,194.00		
Basswood Logs	MBF	12		\$134.00	\$1,608.00		
Mixed Hardwood Logs	MBF	6		\$138.00	\$828.00		
White Ash Logs	MBF	5		\$162.00	\$810.00		
Hard Maple Logs	MBF	1		\$293.00	\$293.00		
Total Estimated Value of Accepted Bid					\$44,444.00		
						Total Bid	
Bidder Name						10% of Total Bid	
Primary Contact						Address	
Phone Number						Date	
email							

**Cutting Regulations:**

- Area 1 (54 Acres) Harvest all merchantable aspen, mixed hardwood and balsam fir. Unmerchantable trees 1" and greater in diameter must be cut at the time of harvest. Leave all oak, pine, hemlock, and standing dead.
- Area 2 (49 Acres) Harvest all trees marked with orange paint and all merchantable ash, balsam fir with 2 or more pulp sticks, and ironwood.
- Area 3 (2 Acres) Harvest all trees marked with orange paint and all merchantable ash, balsam fir with 2 or more pulp sticks, and ironwood.





**Special Regulations:**

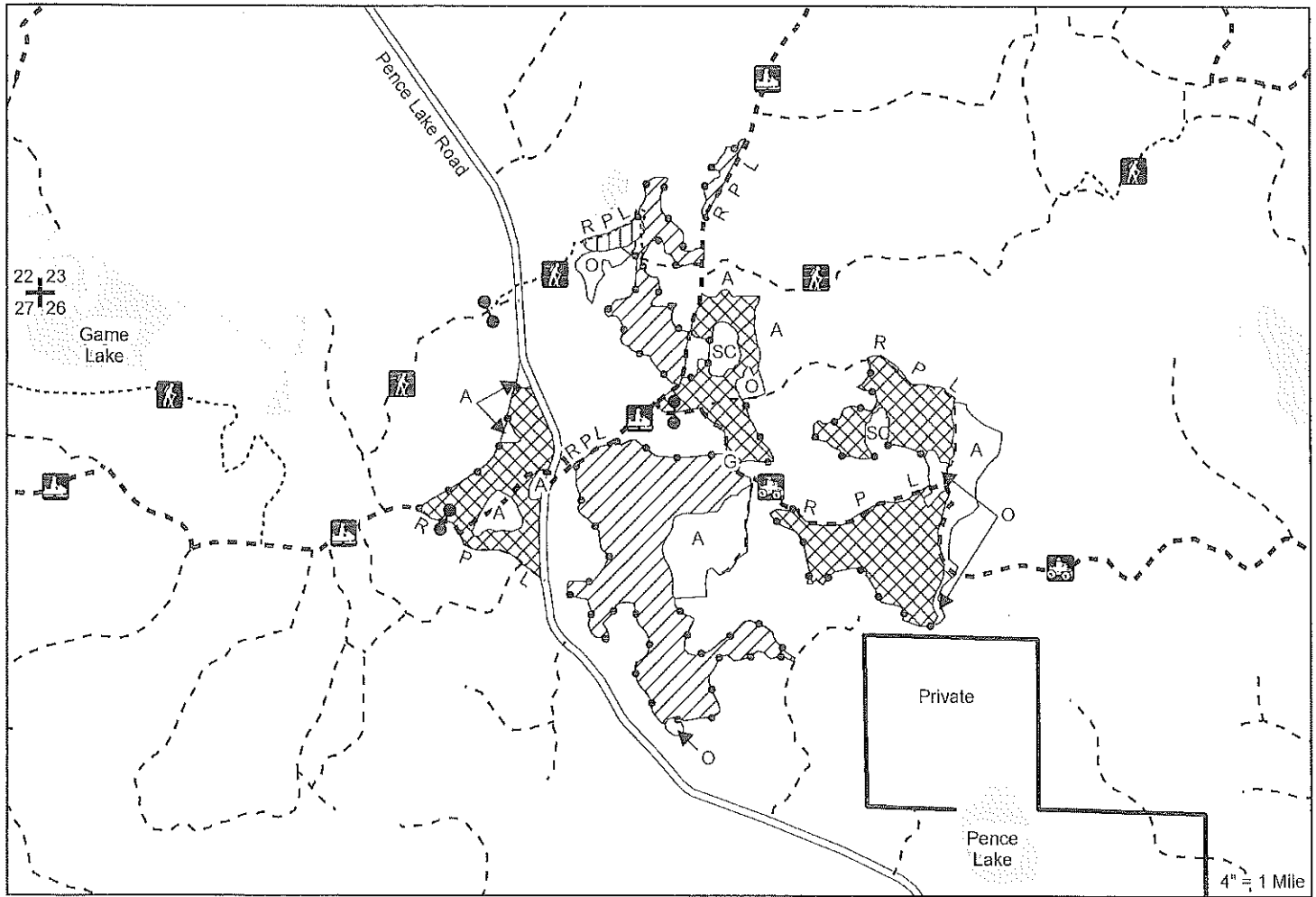
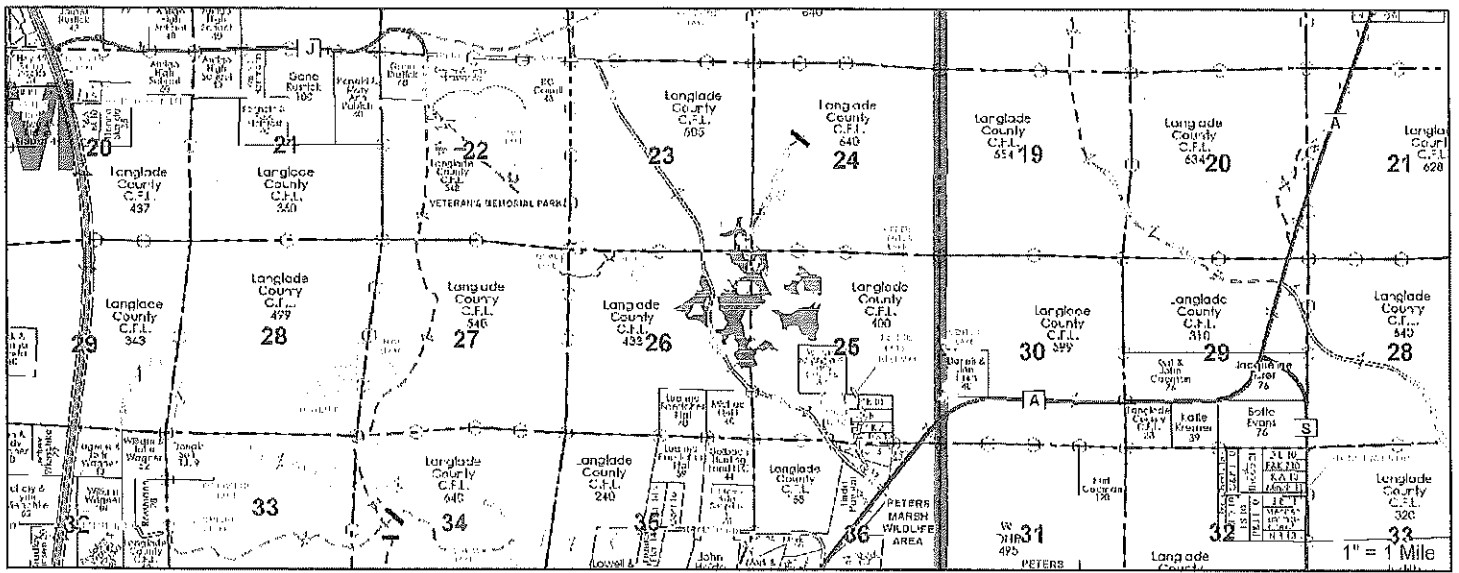



- Oak Wilt – To help prevent introducing oak wilt into this stand, no logging or road work will be permitted from April 15, thru July 15, in Area 2.
- ATV/Snowmobile/Ice Age Trail – Trails must be kept free and clear of slash during all phases of logging.





Bids must be accompanied by 10 percent of the bid price. Contracts must be returned within 30 days of sale. Additional 15 percent must be paid prior to sale start-up. This sale must be completed by December 31, 2028.



### Legend

-  Area 1 (Aspen Coppice) 54 acres
-  Area 2 (Hwd Thinning) 49 acres
-  Area 3 (Pine Thinning) 2 acres
-  Town Road
-  ATV/Snomobile Trail

-  Woods Road
-  Ice Age Trail
-  Lake
-  RPL Red Paint Line
-  Red Paint Line

-  Green Paint Line
-  Aspen Sapings
-  Grass Opening
-  SC Swamp Conifer
-  Gate

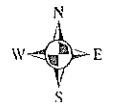

This map is not a survey of any property depicted.

Langlade County Pulp and Timber Sale  
December 3, 2025

Job # 2

Location: Township of Ainsworth (north): Compartments 7 & 8

SESW, S1/2SE Section 7, SWSW Section 8, W1/2NW Section 17, NE1/4, E1/2NW, NWSE Section 18 T34N-R12E  
45.435684, -89.032002

Cutting Area: 80 Acres

Product/Species		Estimated Unit Volume		Minimum Bid Per Unit	Estimated Value	Bid Per Unit	Total
Aspen Pulp	Tons	1,720	(748 cds)	\$8.10	\$13,932.00		
Red Pine Pulp/Logs	Tons	430	(186 cds)	\$27.20	\$11,696.00		
Oak Pulp	Tons	290	(116 cds)	\$4.40	\$1,276.00		
White Spruce Pulp	Tons	220	(100 cds)	\$5.20	\$1,144.00		
Mixed Hardwood Pulp	Tons	150	(62 cds)	\$7.00	\$1,050.00		
Balsam Fir Pulp	Tons	140	(60 cds)	\$2.40	\$336.00		
White Pine Pulp/Logs	Tons	60	(26 cds)	\$4.80	\$288.00		
Red Oak Logs	MBF	28		\$302.00	\$8,456.00		
Mixed Hardwood Logs	MBF	4		\$126.00	\$504.00		
Total Estimated Value of Accepted Bid					\$38,682.00		
						Total Bid	
Bidder Name						10% of Total Bid	
Primary Contact				Address			
Phone Number				Date			
email							

**Cutting Regulations:**

- Area 1 (36 Acres) Harvest all merchantable aspen, mixed hardwood, red pine, spruce, balsam fir and trees marked with orange paint. Unmerchantable trees 1" and greater in diameter must be cut at the time of harvest. Leave all white pine, hemlock, standing dead and oak not marked with orange paint.
- Area 2 (19 Acres) Harvest all trees marked with orange paint and all balsam fir with two or more pulp sticks.
- Area 3 (17 Acres) Harvest all merchantable oak, mixed hardwood, red pine, white pine, spruce and balsam fir. Unmerchantable trees 1" and greater in diameter must be cut at the time of harvest. Leave all trees marked with green paint and standing dead.
- Area 4 (8 Acres) Harvest all merchantable aspen, mixed hardwood, red pine, spruce, balsam fir and trees marked with orange paint. Unmerchantable trees 1" and greater in diameter must be cut at the time of harvest. Leave all white pine, hemlock and standing dead.

**Special Regulations:**

Snowmobile – Trails must be kept free and clear of slash during all phases of logging.

Hot logging / Annosum Regulations – Pine cut between April 1, & September 1, must be removed from the sale area within two (2) weeks of cutting. Treatment of cut pine by a DATCP Certified Pesticide Applicator is required within 24hrs of cutting if harvested between April 1, & November 30. The logger will be responsible for the treatment of pine stumps and all associated costs except the County will provide the chemical and dye. Contact the Forestry Dept. for additional information.

Oak Wilt – To help prevent introducing oak wilt into this stand, no logging or road work will be permitted from April 15, thru July 15, in Area 3.

Seasonal Restriction – Due to the presence of a special concern species, no harvesting or road work will be permitted in Area 4 from May 1 thru July 5.

Bids must be accompanied by 10 percent of the bid price. Contracts must be returned within 30 days of sale. Additional 15 percent must be paid prior to sale start-up. This sale must be completed by December 31, 2027.



Langlade County Pulp and Timber Sale  
December 3, 2025

Job # 3

Location: Township of Price : Compartment 145  
W1/2 NW Sec 1, NE1/4 N1/2SE Sec 2, T32N R12E, S1/2SE Sec 35, T33N R12E  
Lat long 45.287441, -88.952072

Cutting Area: 239 Acres

Product/Species		Estimated Unit Volume		Minimum Bid Per Unit	Estimated Value	Bid Per Unit	Total
Mixed Hardwood Pulp	Tons	1,850	(733 cds)	\$8.50	\$15,725.00		
Basswood Pulp	Tons	760	(392 cds)	\$2.60	\$1,976.00		
Hard Maple Logs	MBF	177		\$361.00	\$63,897.00		
Basswood Logs	MBF	151		\$145.00	\$21,895.00		
White Ash Logs	MBF	33		\$234.00	\$7,722.00		
Yellow Birch Logs	MBF	12		\$145.00	\$1,740.00		
Black Cherry Logs	MBF	5		\$145.00	\$725.00		
Mixed Hardwood Logs	MBF	1		\$149.00	\$149.00		
Total Estimated Value of Accepted Bid					\$113,829.00		
						Total Bid	
Bidder Name						10% of Total Bid	
Primary Contact						Address	
Phone Number						Date	
email							

**Cutting Regulations:**

Area 1 (240 Acres) Harvest all trees marked with orange paint and all merchantable ash and ironwood.

Bids must be accompanied by 10 percent of the bid price. Contracts must be returned within 30 days of sale. Additional 15 percent must be paid prior to sale start-up. This sale must be completed by December 31, 2028.

- MAP ON BACK -

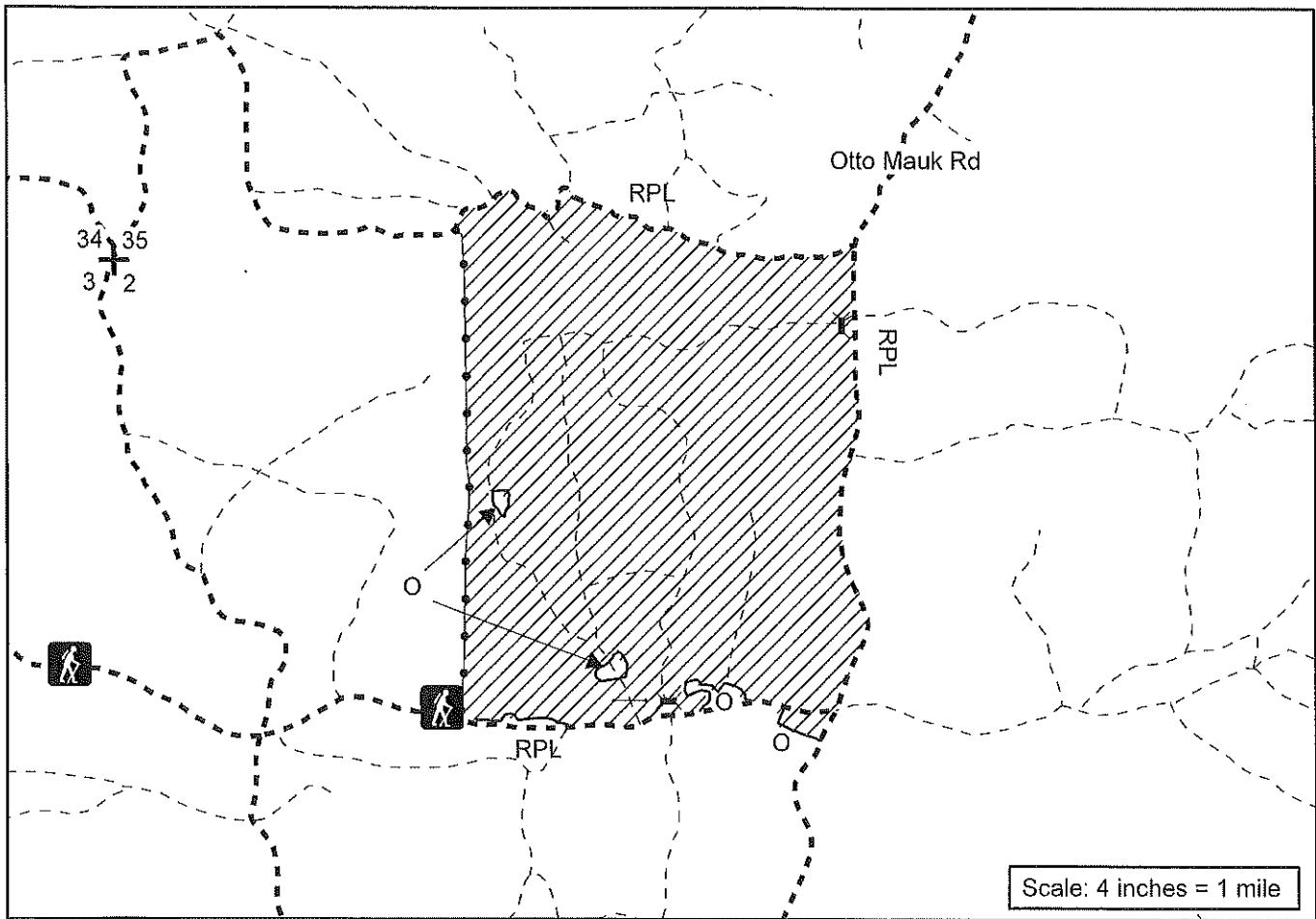
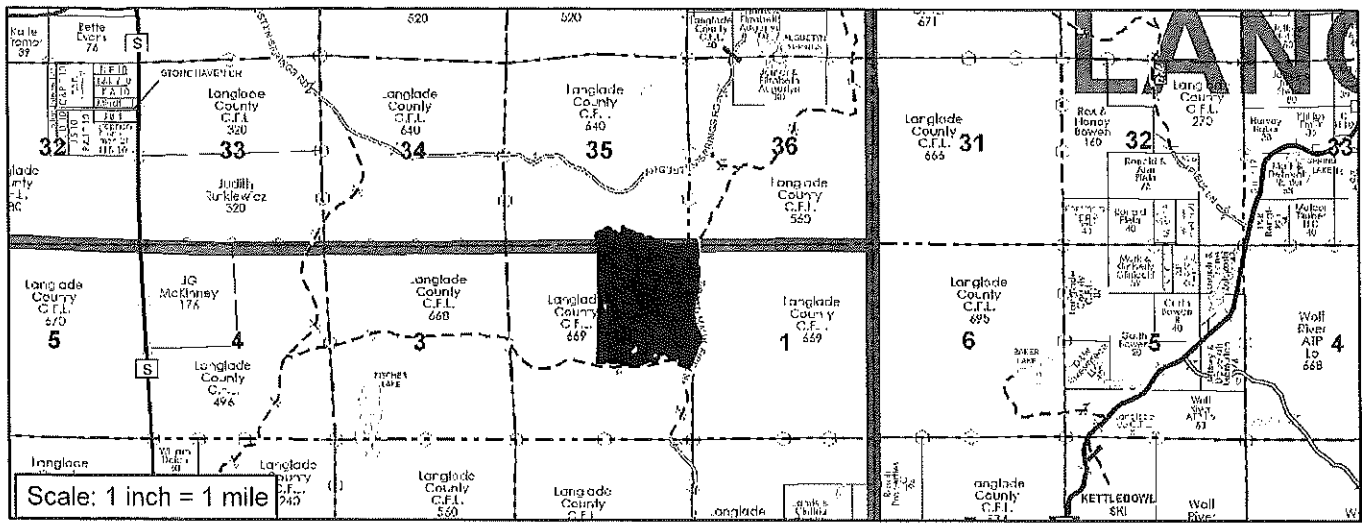

### Legend



Area 1 - Single Tree Selection (239 acres)

--- ATV/Snowmobile Trail

● Red Paint Line (RPL)

--- Woods Road

○ Opening

Ice Age Trail

— Cable Gate

Berm



This map is not a survey of the actual boundary of any property this map depicts.

Langlade County Pulp and Timber Sale  
December 3, 2025

Job # 4

Location: Township of Ainsworth: Compartment 11,16,17  
N1/2NW Sect.28; SENE, E1/2SE Sect.29; SENE, NESE, SWSE, E1/2SW Sect. 32; SESW, Sect. 33, T34N-R12E  
Lat long: 45.386217, -89.013041

Cutting Area: 111 Acres

Product/Species	Estimated		Minimum Bid Per Unit	Estimated		Total
	Unit	Volume		Value	Bid Per Unit	
Red Pine Pulp/Logs	Tons	2,585 ( 1,123 cds)	\$31.00	\$80,135.00		
Aspen Pulp	Tons	1,065 ( 463 cds)	\$9.10	\$9,691.50		
Mixed Hardwood Pulp	Tons	258 ( 107 cds)	\$9.00	\$2,322.00		
Balsam Fir Pulp	Tons	240 ( 104 cds)	\$3.60	\$864.00		
Jackpine Pulp	Tons	67 ( 32 cds)	\$6.90	\$462.30		
White Pine Pulp/Logs	Tons	52 ( 25 cds)	\$8.10	\$421.20		
Mixed Hardwood Logs	MBF	4	\$149.00	\$596.00		
Total Estimated Value of Accepted Bid				\$94,492.00		Total Bid
Bidder Name				10% of Total Bid		
Primary Contact				Address		
Phone Number				Date		
email						

**Cutting Regulations:**

- Area 1 (38 Acres) - Harvest all merchantable aspen, mixed hardwood, white pine, red pine, and balsam fir. Unmerchantable trees 1" and greater in diameter must be cut at the time of harvest. Leave all oak, hemlock, spruce, tamarack, standing dead, and trees marked with green paint.
- Area 2 (65 Acres) - Cut all rows of pine marked with green paint & all trees marked with orange paint.
- Area 3 (5 Acres) - Harvest all merchantable aspen, mixed hardwood, pine species, and balsam fir. Unmerchantable trees 1" and greater in diameter must be cut at the time of harvest. Leave all oak, hemlock, tamarack, spruce, standing dead, and trees marked with green paint.
- Area 4 (3 Acres) - Harvest all merchantable mixed hardwood, balsam fir, white pine, red pine, and aspen 5" and greater in diameter. Great care must be taken to minimize damage to understory trees.

**Special Regulations:**

- ATV/Snowmobile Trails – Trails must be kept free and clear of slash during all phases of logging.
- Annosum Regulations – Annosum Regulations – Treatment of cut pine by a DATCP Certified Pesticide Applicator is required within 24hrs of cutting if harvested between April 1, & November 30. The logger will be responsible for the treatment of pine stumps and all associated costs except the County will provide the chemical and dye. Contact the Forestry Dept. for additional information.
- Hot Logging – Pine cut between April 1, & September 1, must be removed from the sale area within two (2) weeks of cutting.
- Seasonal Restriction – Due to the presence of a special concern species, no harvesting or road work will be permitted:
  - Area 1: May 1st to September 18th
  - Area 3: May 20th to September 18th

Bids must be accompanied by 10 percent of the bid price. Contracts must be returned within 30 days of sale. Additional 15 percent must be paid prior to sale start-up. This sale must be completed by December 31, 2028.

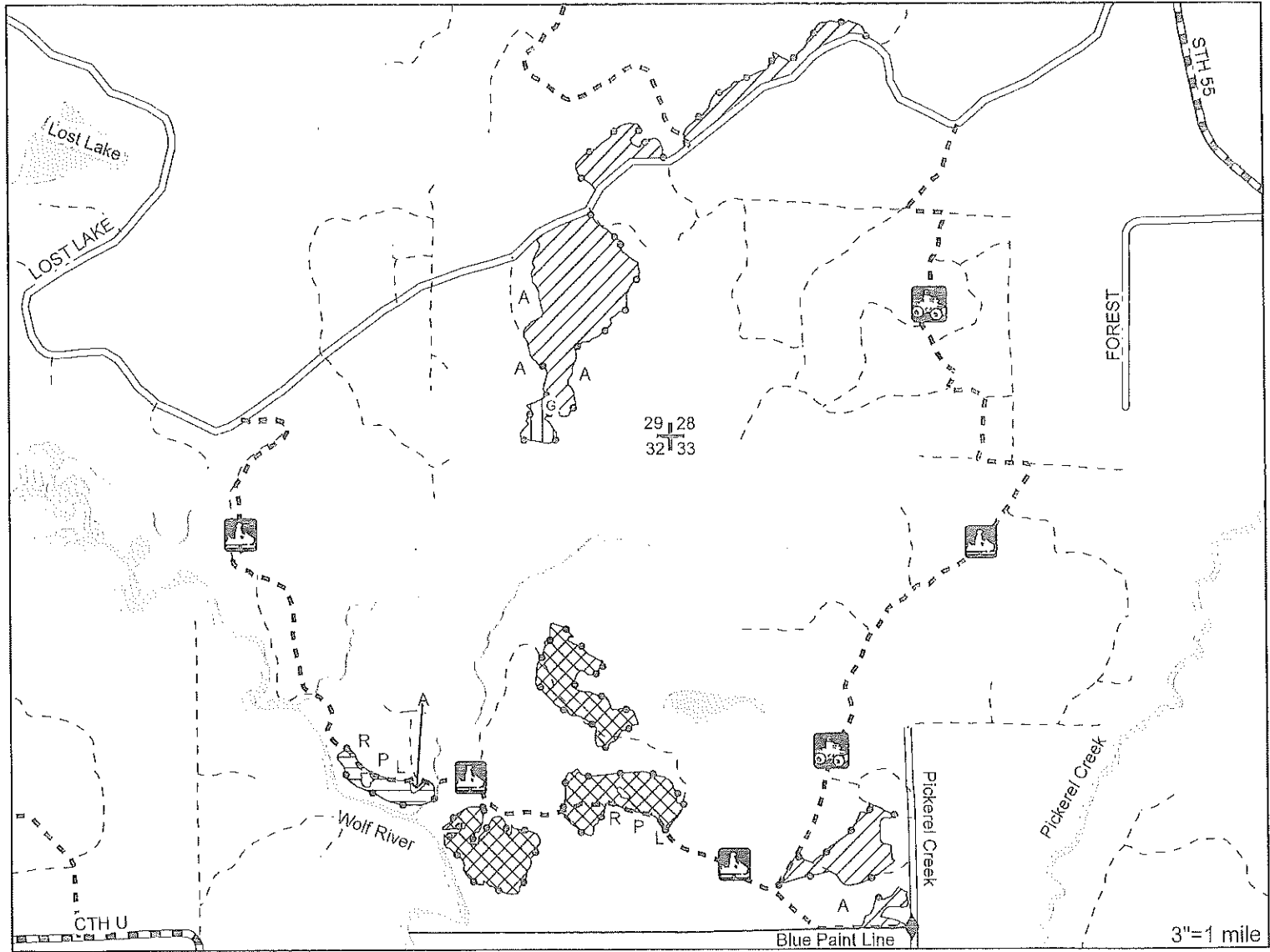
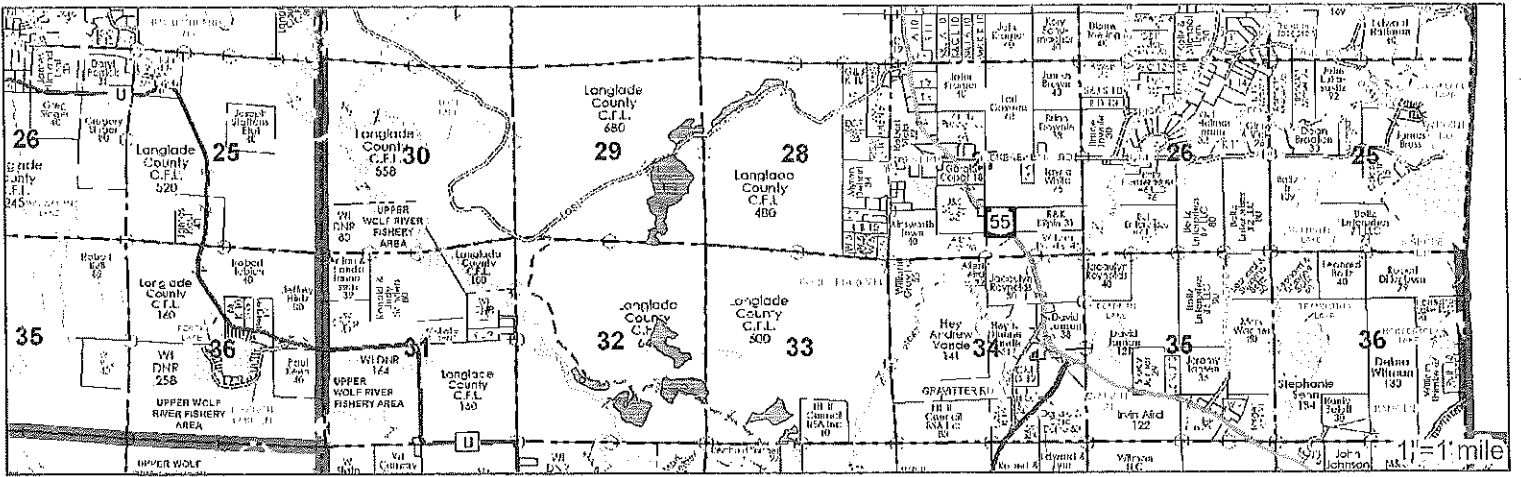

**Legend**

Area 1 - Aspen Coppice - 38 Acres	Highways	Red Paint Line
Area 2 - Red Pine Thinning - 65 Acres	Snowmobile Trail	Green Paint Line
Area 3 - Birch Seed Tree - 5 Acres	ATV Trail	RPL Red Paint Line
Area 4 - Over Story Removal - 3 Acres	Town Road	Survey Marker
	Woods Roads	A Aspen

This map is not a survey of any property depicted.

Langlade County Pulp and Timber Sale  
December 3, 2025

Job # 5

Location: Township of Parrish: Compartment 60, 65, & 66  
S1/2NE, N1/2SE, NWSW, Sect. 16; NESE, Sect.20; NW, NWSW, Sect. 21, T34N-R9E  
Lat long: 45.418487, -89.376412

Cutting Area: 102 Acres

Product/Species	Unit	Estimated Volume		Minimum Bid Per Unit	Estimated Value	Bid Per Unit	Total
Aspen Pulp	Tons	2104	(915 cds)	\$7.50	\$15,780.00		
Mixed Hardwood Pulp	Tons	1783	(743 cds)	\$7.10	\$12,659.30		
Balsam Fir Pulp	Tons	530	(265 cds)	\$2.60	\$1,378.00		
Basswood Pulp	Tons	30	( 15 cds)	\$2.20	\$66.00		
Red Maple Logs	MBF	21		\$138.00	\$2,898.00		
Hard Maple Logs	MBF	6		\$349.00	\$2,094.00		
Basswood Logs	MBF	4		\$124.00	\$496.00		
Mixed Hardwood Logs	MBF	2		\$130.00	\$260.00		
Total Estimated Value of Accepted Bid					\$35,631.30		Total Bid
Bidder Name						10% of Total Bid	
Primary Contact						Address	
Phone Number						Date	
email							

**Cutting Regulations:**

- Area 1 (42 Acres) - Harvest all trees marked with orange paint and all merchantable ash, ironwood, and balsam fir with 2 or more pulp sticks.
- Area 2 (60 Acres) - Harvest all merchantable aspen, mixed hardwood, and balsam fir. Unmerchantable trees 1" and greater in diameter must be cut at the time of harvest. Leave all oak, pine, hemlock, spruce, tamarack, standing dead, and trees marked with green paint.

**Special Regulations:**

ATV/Snowmobile/Ice Age Trail – Trails must be kept free and clear of slash during all phases of logging.





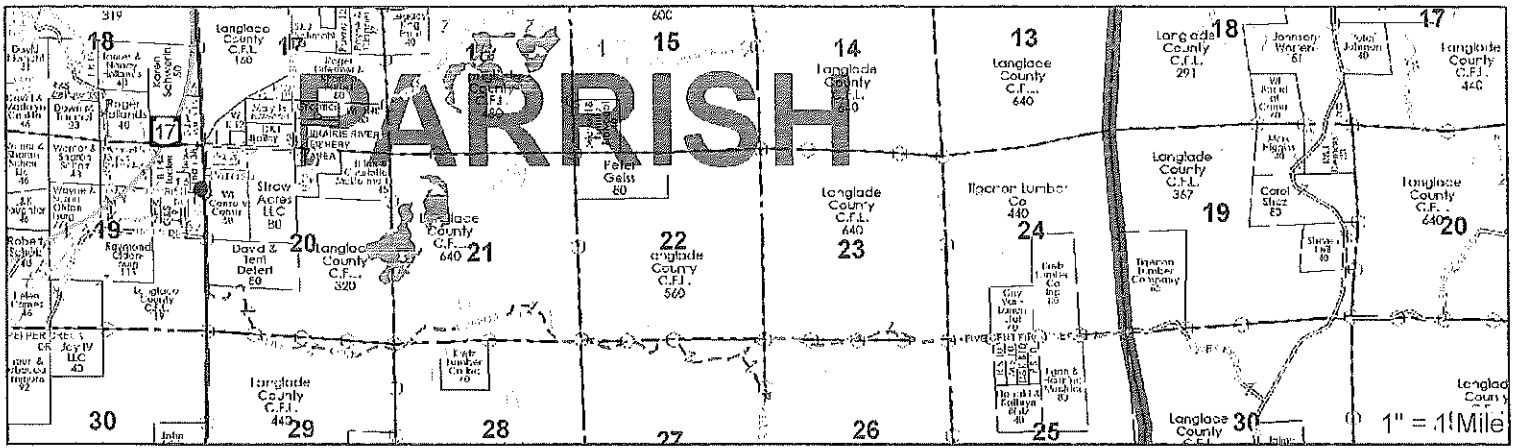

Seasonal Restriction – This sale can only be harvested on very dry ground conditions or when the ground is frozen.

Bids must be accompanied by 10 percent of the bid price. Contracts must be returned within 30 days of sale. Additional 15 percent must be paid prior to sale start-up. This sale must be completed by December 31, 2028.

- MAP ON BACK -



### Legend

-  Area 1 - Single Tree Selection- 42 Acres
-  Area 2 - Aspen/ Red Maple Coppice - 60 Acres
-  - - - - - ATV Trail
-  - - - - - Woods Roads
-  A Aspen
-  Ice Age Trail
-  Red Paint Line
-  -G- Green Paint Line
-  LBA Alder Brush
-  Culvert

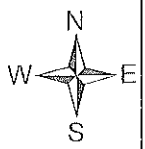

This map is not a survey of any property depicted

Langlade County Pulp and Timber Sale  
December 3, 2025

Job # 6  
 Location: Township of Summit: Compartment 79  
 NWSW, Sect. 5 T33N-R9E  
 Lat long: 45.371829, -89.399794  
 Cutting Area: 36 Acres

Product/Species		Estimated		Minimum Bid	Estimated		
	Unit	Volume		Per Unit	Value	Bid Per Unit	Total
Mixed Hardwood Pulp	Tons	417	(173 cds)	\$7.50	\$3,127.50	_____	_____
Balsam Fir Pulp	Tons	230	(100 cds)	\$3.10	\$713.00	_____	_____
Aspen Pulp	Tons	70	(30cds)	\$8.30	\$581.00	_____	_____
Basswood Pulp	Tons	10	(5 cds)	\$2.50	\$25.00	_____	_____
Hard Maple Logs	MBF	7		\$323.00	\$2,261.00	_____	_____
Basswood Logs	MBF	2		\$128.00	\$256.00	_____	_____
Mixed Hardwood Logs	MBF	2		\$131.00	\$262.00	_____	_____
Total Estimated Value of Accepted Bid					<u>\$7,225.50</u>		Total Bid
						10% of Total Bid	_____
Bidder Name	_____						
Primary Contact	_____					Address _____	
Phone Number	_____					Date _____	
email	_____						

**Cutting Regulations:**

Area 1 (25 Acres) - Harvest all trees marked with orange paint and all merchantable ash, balsam fir, elm and ironwood.

Area 2 ( 11 Acres) -Harvest all merchantable aspen, mixed hardwood, and balsam fir. Unmerchantable trees 1" and greater in diameter must be cut at the time of harvest. Leave all oak, pine, hemlock, spruce, tamarack, standing dead, and trees marked with green paint.

**Special Regulations:**

Seasonal Restriction – This sale can only be harvested on very dry ground conditions or when the ground is frozen.







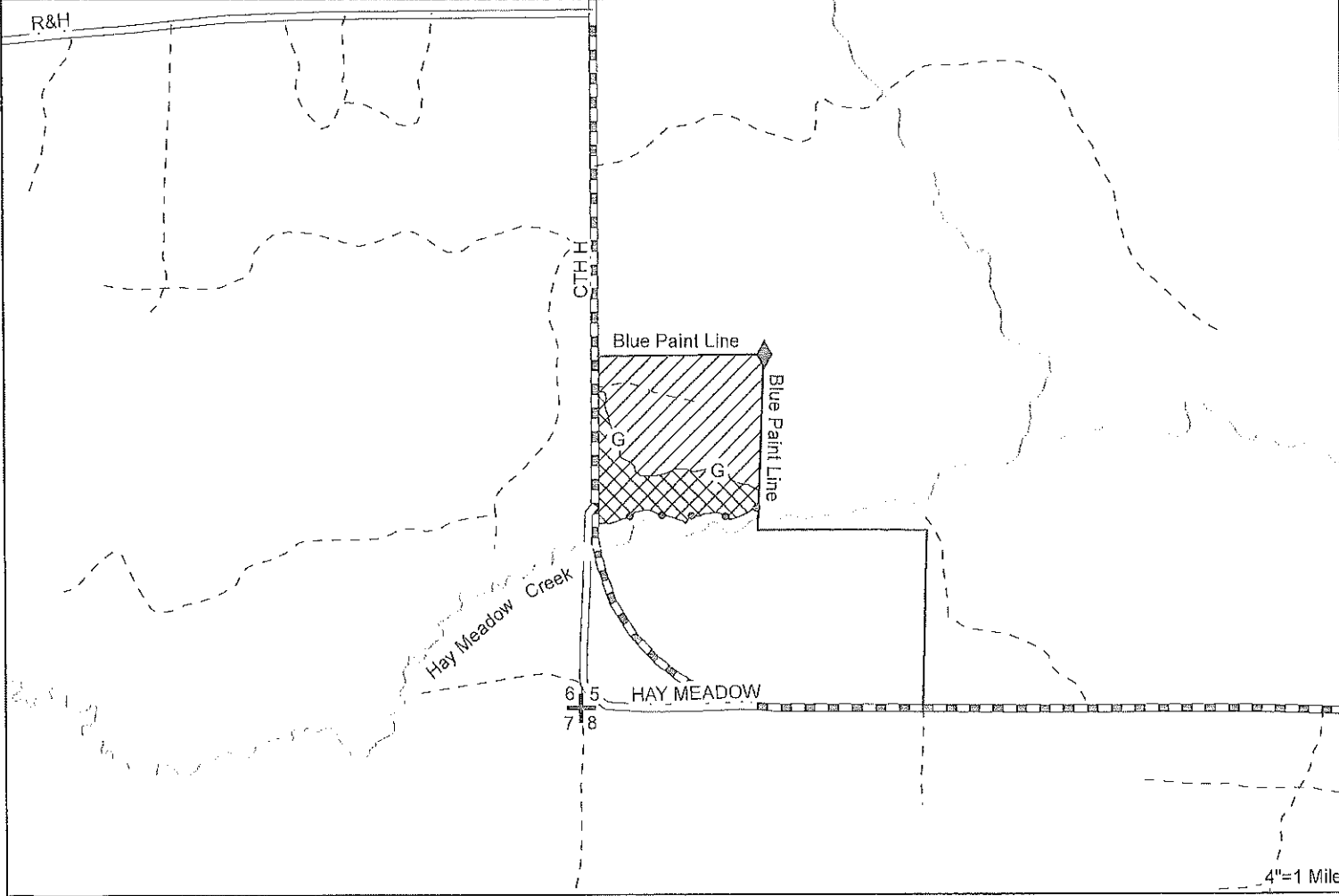
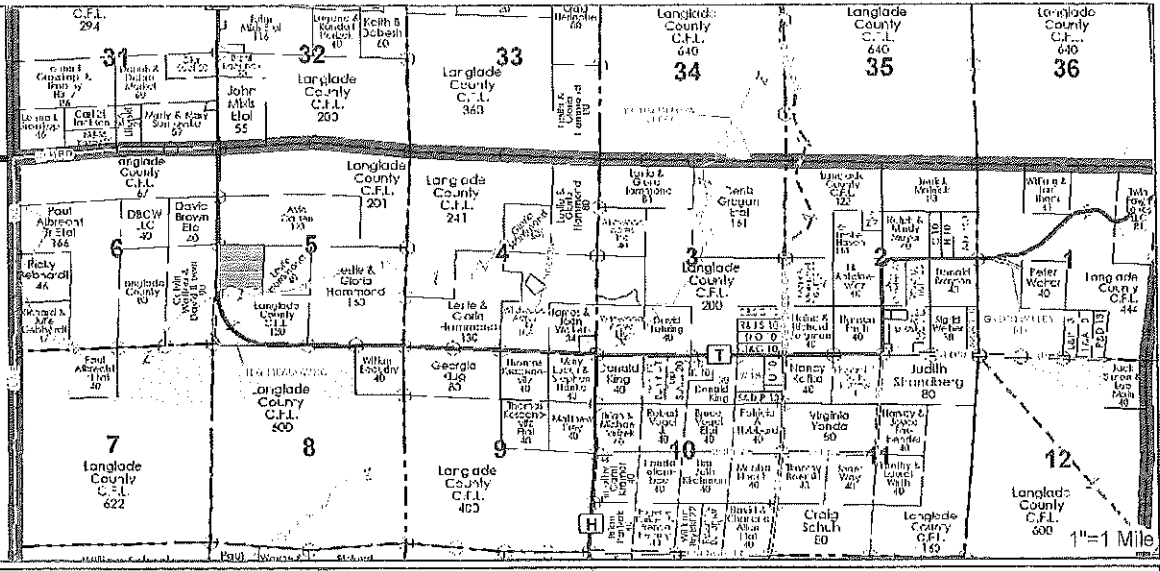

Bids must be accompanied by 10 percent of the bid price. Contracts must be returned within 30 days of sale. Additional 15 percent must be paid prior to sale start-up. This sale must be completed by December 31, 2028.

- MAP ON BACK -

T34N  
T33N



**Legend**

-  Area 1 - Single Tree Selection - 25 Acres
-  Area 2 - Aspen/ Red Maple Coppice - 11 Acres
-  Town Road
-  Woods Roads
-  Highway
-  Green Paint Line
-  Survey Marker
-  Red Paint Line



This map is not a survey of any property depicted

Langlade County Pulp and Timber Sale  
December 3, 2025

Job # 7

Location: Township of Ackley: Compartment 167  
SESE, Sect. 9; W1/2SW, Sect. 10; W1/2NW, Sect. 15; E1/2NE, Sect. 16; T31N-R9E  
Lat long: 45.174902, -89.367587

Cutting Area: 157 Acres

Product/Species	Estimated Unit Volume	Minimum Bid Per Unit	Estimated Value	Bid Per Unit	Total
Mixed Hardwood Pulp	Tons 2453 (1022 cds)	\$7.30	\$17,906.90		
Aspen Pulp	Tons 1035 (450 cds)	\$6.80	\$7,038.00		
Red Oak Pulp	Tons 45 (18 cds)	\$7.70	\$346.50		
Ash Logs	MBF 70	\$160.00	\$11,200.00		
Red Maple Logs	MBF 40	\$124.00	\$4,960.00		
Red Oak Logs	MBF 2	\$361.00	\$722.00		
Mixed Hardwood Logs	MBF 2	\$131.00	\$262.00		
Total Estimated Value of Accepted Bid				\$42,435.40	
					Total Bid
Bidder Name				10% of Total Bid	
Primary Contact				Address	
Phone Number				Date	
email					

**Cutting Regulations:**

- Area 1 (100 Acres) - Harvest all trees marked with orange paint and all merchantable ash, and ironwood.
- Area 2 (57 Acres) - Harvest all merchantable aspen and mixed hardwood. Unmerchantable trees 1" and greater in diameter must be cut at the time of harvest. Leave all oak, pine, hemlock, tamarack, standing dead, and trees marked with green paint.

**Special Regulations:**

Seasonal Restriction – This sale can only be harvested when the ground is frozen.

Bids must be accompanied by 10 percent of the bid price. Contracts must be returned within 30 days of sale. Additional 15 percent must be paid prior to sale start-up. This sale must be completed by April 1, 2028.

- MAP ON BACK -

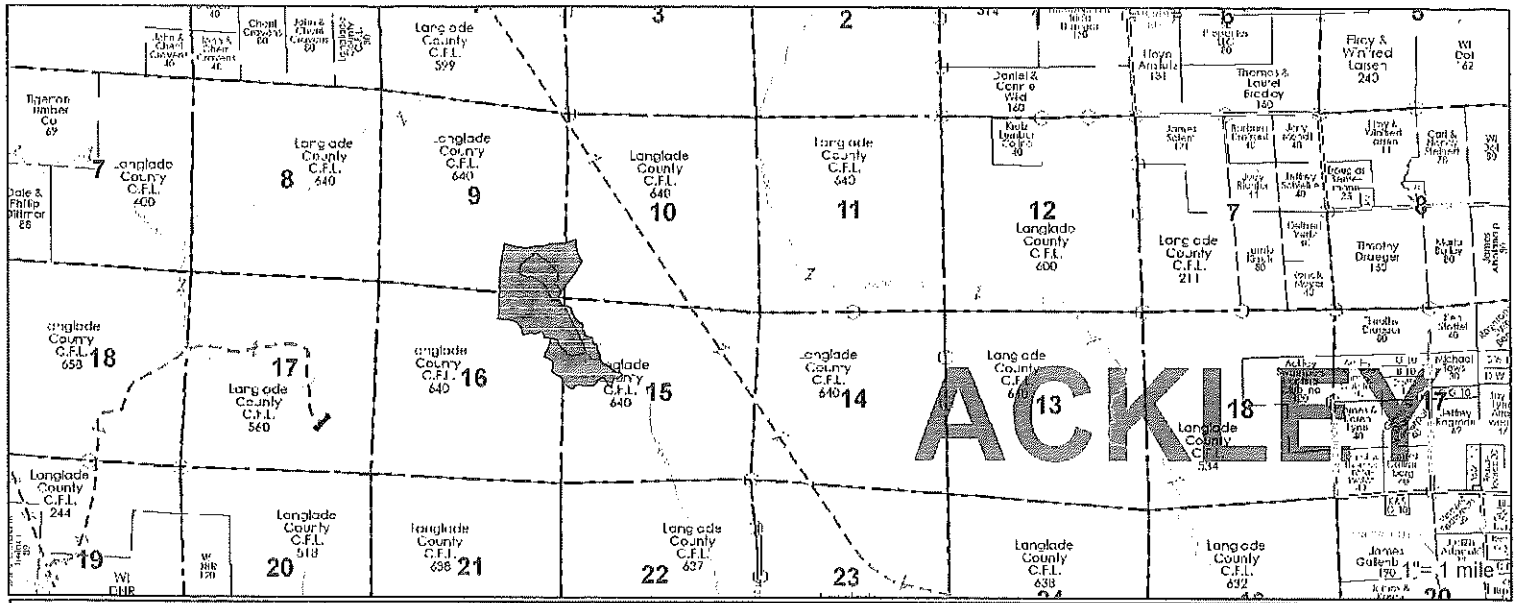

### Legend

- Area 1 - Single Tree Selection - (100 Acres)
- Area 2 - Aspen/ Red Maple Coppice - (57 Acres)
- LBA Alder Brush
- Woods Roads
- Green Paint Line
- Red Paint Line
- RPL Red Paint Line
- A Aspen



This map is not a survey of any property depicted

Langlade County Pulp and Timber Sale  
December 3, 2025

Job # 8

Location: Township of Ackley & Vilas: Compartments 154, 157, 160  
NW1/4, W1/2SW Section 3, NENW, NWNE, SENW, S1/2NE, N1/2SW, N1/2SE SWSW Section 4, SESE Section 5,  
NENE Section 8, NWNW Section 9 T31N R9E, SESE Section 32, W1/2SW, SESW Section 33 T32N R9E  
Lat long: 45.197070 -89.373509

Cutting Area: 192 Acres Bidder must choose 5 inch top or whole tree option.

<b>5 Inch Top Option</b>						
Product/Species	Unit	Volume	Per Unit	Value	Bid Per Unit	Total
Mixed Hardwood Pulp	Tons	5,750 (2,400 cds)	\$8.00	\$46,000.00		
Aspen Pulp	Tons	3,750 (1,666 cds)	\$8.00	\$30,000.00		
Basswood Pulp	Tons	70 (36 cds)	\$2.40	\$168.00		
Red Maple Logs	MBF	137	\$140.00	\$19,180.00		
Basswood Logs	MBF	16	\$136.00	\$2,176.00		
Hard Maple Logs	MBF	4	\$340.00	\$1,360.00		
Mixed Hardwood Logs	MBF	1	\$140.00	\$140.00		
Total Estimated Value of Accepted Bid				\$97,524.00		
<b>Whole Tree Option</b>						
Product/Species	Unit	Volume	Per Unit	Value	Bid Per Unit	Total
Mixed Hardwood Whole Tree	Tons	14,565 (4,450 cds*) (1,733 cds equivalent biomass)	\$6.98	\$101,663.70		
Total Estimated Value of Accepted Bid				\$101,663.70		
* Includes 158 MBF of hardwood logs						
<b>Bid only one option (5 Inch Top or Whole Tree)</b>					Total Bid	
Bidder Name					10% of Total Bid	
Primary Contact			Address			
Phone Number			Date			
email						

**Cutting Regulations:**

- Area 1 (52 Acres) Harvest all trees marked with orange paint and all merchantable ash, aspen, elm and ironwood.
- Area 2 (48 Acres) Harvest all merchantable aspen and mixed hardwood. Unmerchantable trees 1" and greater in diameter must be cut at the time of harvest. Leave all oak, pine, hemlock, and standing dead.
- Area 3 (92 Acres) Harvest all merchantable aspen and mixed hardwood. Unmerchantable trees 1" and greater in diameter must be cut at the time of harvest. Leave all oak, pine, hemlock, and standing dead.

**Special Regulations:**

Seasonal Restriction – This sale can only be harvested when the ground is frozen.

Bids must be accompanied by 10 percent of the bid price. Contracts must be returned within 30 days of sale. Additional 15 percent must be paid prior to sale start-up. This sale must be completed by April 1, 2028.

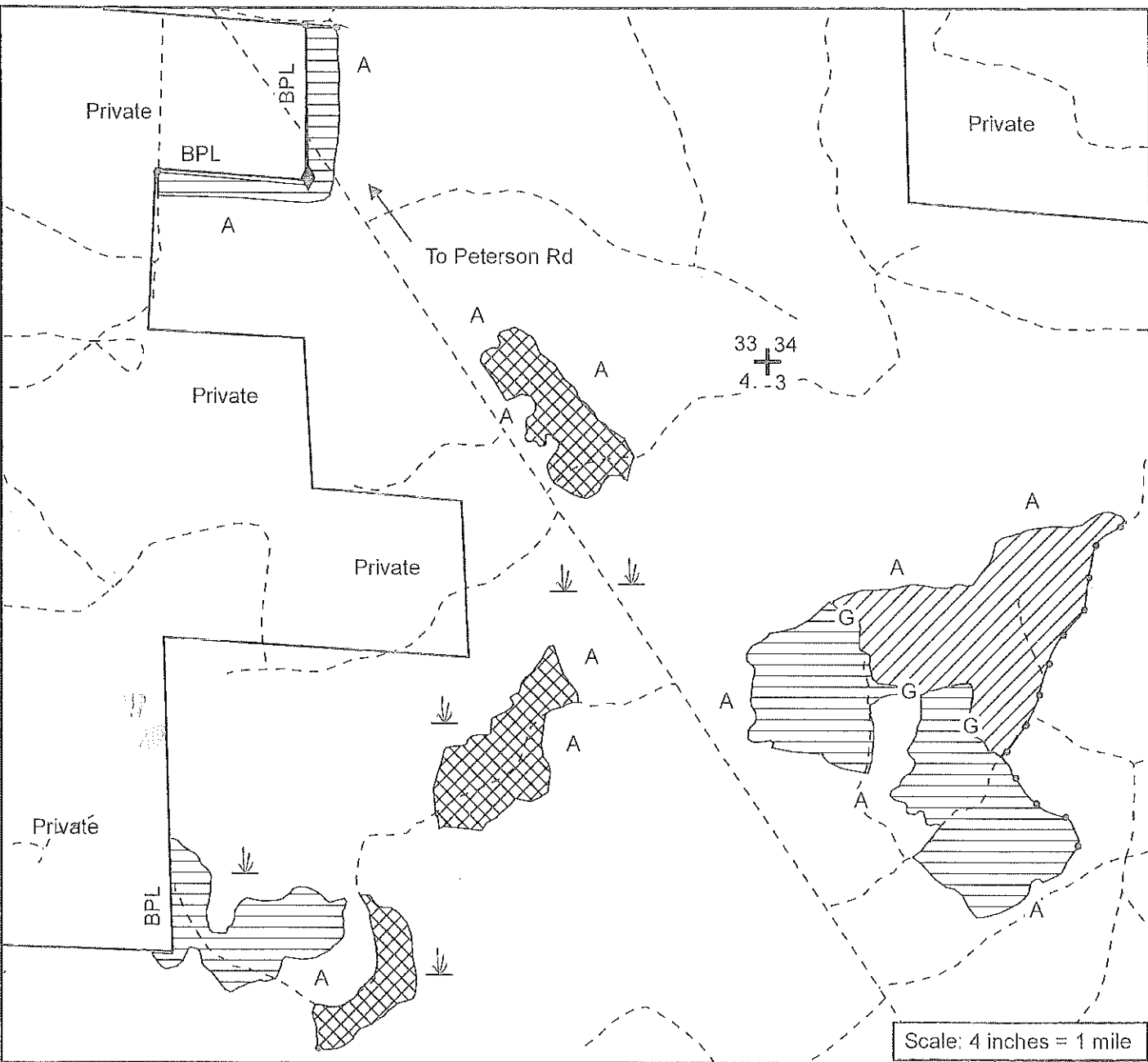
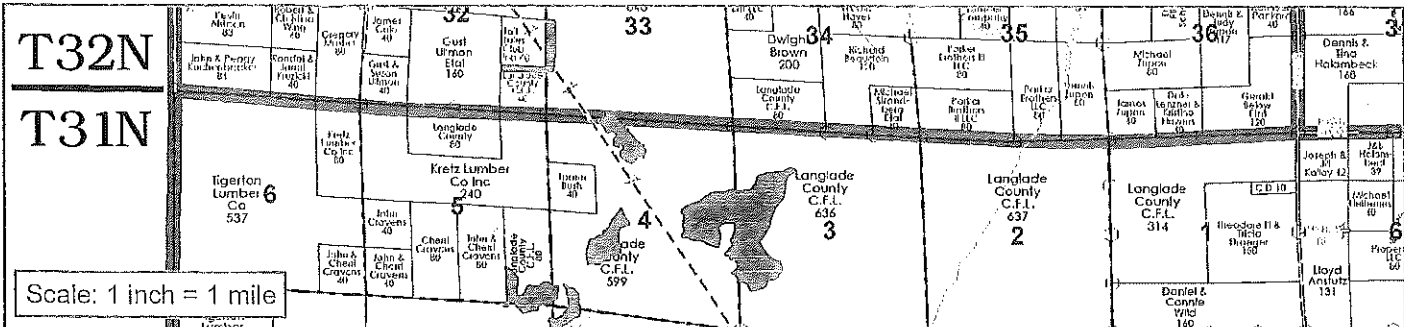

**Legend**

- Area 1 - Red Maple Thinning (52 acres)
- Area 2 - Red Maple Coppice (48 acres)
- Area 3 - Aspen Coppice (92 acres)
- Red Paint Line (RPL)
- Blue Paint Line
- G - Green Paint Line
- Survey Marker
- A Aspen Sprouts
- Swamp
- Woods Road

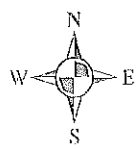

This map is not a survey of the actual boundary of any property this map depicts.

Langlade County Pulp and Timber Sale  
December 3, 2025

Job # 9

Location: Township of Elcho: Compartment 33, 34  
NWSW, SWSW Sect. 14, SENW, NESW, SESW, SWNE, SE1/4 Sect. 15, NENW, NWNE, NENE,  
SENW, SWNE Sect. 22, NWNW Sect. 23, T34N-R10E  
Lat long 45.428350 -89.221510

Cutting Area: 217 Acres

Product/Species	Estimated Unit	Volume	Minimum Bid Per Unit	Estimated Value	Bid Per Unit	Total
Mixed Hardwood Pulp	Tons	2,250 (937 cds)	\$7.00	\$15,750.00		
Aspen Pulp	Tons	1,730 (752 cds)	\$8.00	\$13,840.00		
Basswood Pulp	Tons	510 (255 cds)	\$2.00	\$1,020.00		
Oak Pulp	Tons	120 (48 cds)	\$7.70	\$924.00		
Balsam Fir Pulp	Tons	50 (22 cds)	\$3.20	\$160.00		
Hemlock Pulp	Tons	20 (9 cds)	\$4.30	\$86.00		
White Ash Logs	MBF	40	\$151.00	\$6,040.00		
Hard Maple Logs	MBF	37	\$340.00	\$12,580.00		
Basswood Logs	MBF	30	\$153.00	\$4,590.00		
Red Maple Logs	MBF	25	\$163.00	\$4,075.00		
Red Oak Logs	MBF	7	\$298.00	\$2,086.00		
Mixed Hardwood Logs	MBF	3	\$149.00	\$447.00		
Total Estimated Value of Accepted Bid				\$61,598.00		Total Bid
Bidder Name _____					10% of Total Bid _____	
Primary Contact _____			Address _____			
Phone Number _____			Date _____			
email _____						

**Cutting Regulations:**

- Area 1 (157 Acres) Harvest all trees marked with orange paint and all merchantable ash, balsam fir, elm and ironwood.
- Area 2 (44 Acres) Harvest all merchantable mixed hardwood and balsam fir. Do not cut any trees marked with green paint. Unmerchantable trees 1" and greater in diameter must be cut at the time of harvest. Leave all oak, pine, hemlock, yellow birch and standing dead.
- Area 3 (16 Acres) Harvest all trees marked with orange paint and all merchantable ash, balsam fir, elm and ironwood.

**Special Regulations:**

Oak Wilt – To help prevent introducing oak wilt into this stand, no logging or road work will be permitted from April 15, thru July 15, in Area 3.







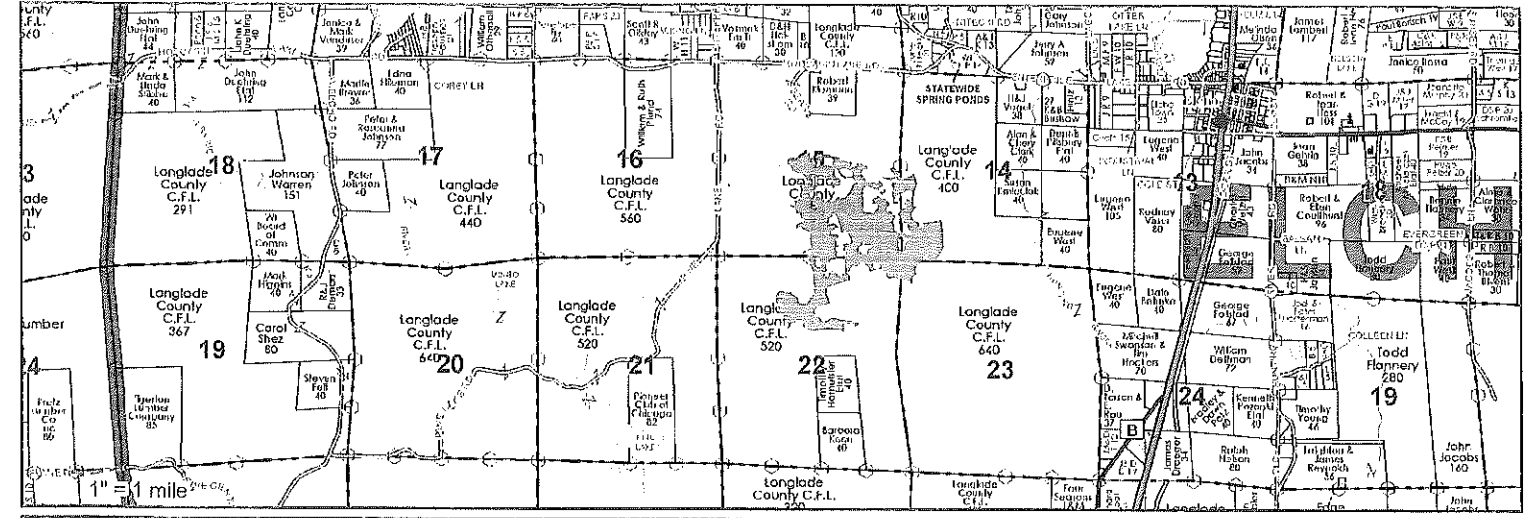







Seasonal Restriction: Harvesting may not occur from Dec 15, to Feb 28, when groomable snow cover is present.

Note: Due to varying degrees of damage due to Emerald Ash Borer ash log volumes may vary.

Bids must be accompanied by 10 percent of the bid price. Contracts must be returned within 30 days of sale. Additional 15 percent must be paid prior to sale start-up. This sale must be completed by December 31, 2028.



**Legend**

- |  |   |   |  |
|--|---|---|--|
|  Area 1 Hwd Thinning (157 acres) |  Area 2 Aspen/ Red Maple Coppice (44 acres) |  Cross Country Ski Trail |  N                |
|  Area 3 Hwd Thinning (16 acres)  |  Town Road                                  |  Berm                    |  Wetland          |
|  Woods Road                      |   |  Gate                    |  A Aspen Saplings |
|  |   |  Red Line                |  O Grass Opening  |
|  |   |  RPL Red Line            |  —G— Green Line   |

This map is not a survey of any property depicted

Langlade County Pulp and Timber Sale  
December 3, 2025

Job # 10

Location: Township of Parrish: Compartment 68  
SWNW, SENW, SWNE, NWSW, NESW, NWSE, SWSW, SESW, SWSE Sect. 28 T34N-R9E  
Lat long 45.400000 -89.365398

Cutting Area: 101 Acres

Product/Species		Estimated		Minimum Bid	Estimated	Bid Per Unit	Total
		Unit	Volume	Per Unit	Value		
Mixed Hardwood Pulp	Tons	1340	(558 cds)	\$7.50	\$10,050.00		
Aspen Pulp	Tons	350	(152 cds)	\$8.00	\$2,800.00		
Tamarack Pulp	Tons	140	(61 cds)	\$5.40	\$756.00		
Hemlock	Tons	115	(50 cds)	\$4.00	\$460.00		
Balsam Fir Pulp	Tons	90	(39 cds)	\$3.00	\$270.00		
Basswood Pulp	Tons	55	(27 cds)	\$2.70	\$148.50		
Cedar Pulp	Tons	20	(12 cds)	\$4.00	\$80.00		
Black Spruce Pulp	Tons	5	(2 cds)	\$4.40	\$22.00		
White Pine Pulp	Tons	5	(2 cds)	\$4.50	\$22.50		
Red Maple Logs	MBF	37		\$158.00	\$5,846.00		
Hard Maple Logs	MBF	25		\$361.00	\$9,025.00		
Basswood Logs	MBF	10		\$162.00	\$1,620.00		
Yellow Birch Logs	MBF	9		\$170.00	\$1,530.00		
Ash Logs	MBF	6		\$180.00	\$1,080.00		
Mixed Hardwood Logs	MBF	1		\$149.00	\$149.00		
Total Estimated Value of Accepted Bid					\$33,859.00		Total Bid
Bidder Name						10% of Total Bid	
Primary Contact						Address	
Phone Number						Date	
email							

**Cutting Regulations:**

- Area 1 (41 acres) Harvest all trees marked with orange paint and all merchantable ash, balsam fir, elm and ironwood.
- Area 2 (32 Acres) Harvest all merchantable mixed hardwood, balsam fir and aspen 5" in diameter and greater. Do not cut any green marked trees. Great care must be taken to minimize damage to understory trees. Leave all oak, pine, hemlock, spruce and standing dead.
- Area 3 (22 Acres) Harvest all merchantable aspen, mixed hardwood, tamarack and balsam fir. Do not cut any trees marked with green paint. Unmerchantable trees 1" and greater in diameter must be cut at the time of harvest. Leave all oak, pine, hemlock, spruce and standing dead.
- Area 4 (6 Acres) Harvest all merchantable aspen, mixed hardwood, tamarack, white pine, spruce and balsam fir. Do not cut any trees marked with green paint. Unmerchantable trees 1" and greater in diameter must be cut at the time of harvest. Leave all oak and standing dead.

**Special Regulations:**

Note – Approximately 40% of this sale will require very dry or frozen ground. Area 4 will require frozen ground. Portions of area 2 and 3 will require dry or frozen ground.

Bids must be accompanied by 10 percent of the bid price. Contracts must be returned within 30 days of sale. Additional 15 percent must be paid prior to sale start-up. This sale must be completed by April 1, 2028.



Langlade County Pulp and Timber Sale  
December 3, 2025

Job # 11

Location: Township of Price : Compartment 147  
NENW, SWNW, E1/2SW Sec 9 T32N R12E  
45.27124, -89.0054

Cutting Area: 73 Acres

Product/Species	Unit	Estimated		Minimum Bid Per Unit	Estimated Value	Bid Per Unit	Total
		Volume					
Aspen Pulp	Tons	1810	(787cds)	\$8.50	\$15,385.00		
Mixed Hardwood Pulp	Tons	216	(94cds)	\$7.60	\$1,641.60		
Basswood Pulp	Tons	126	(63cds)	\$2.30	\$289.80		
Red Pine Pulp	Tons	74	(32cds)	\$13.10	\$969.40		
Balsam Fir Pulp	Tons	16	(7cds)	\$2.90	\$46.40		
Basswood Logs	MBF	29		\$122.00	\$3,538.00		
Mixed Hardwood Logs	MBF	10		\$175.00	\$1,750.00		
Total Estimated Value of Accepted Bid					\$23,620.20		
						Total Bid	
Bidder Name _____						10% of Total Bid _____	
Primary Contact _____				Address _____			
Phone Number _____				Date _____			
email _____							

**Cutting Regulations:**

- Area 1 (36 Acres) Harvest all trees marked with orange paint and all merchantable ash, aspen, balsam fir, elm and ironwood.
- Area 2 (24 Acres) Harvest all merchantable aspen, mixed hardwood, and balsam fir. Unmerchantable trees 1" and greater in diameter must be cut at the time of harvest. Leave all oak, pine, hemlock, and standing dead.
- Area 3 (13 Acres) Harvest all trees marked with orange paint and all merchantable aspen.

**Special Regulations:**

- Annosum Regulations – Treatment of cut pine by a DATCP Certified Pesticide Applicator is required within 24hrs of cutting if harvested between April 1, & November 30. The logger will be responsible for the treatment of pine stumps and all associated costs except the County will provide the chemical and dye. Contact the Forestry Dept. for additional information.
- Hot Logging – Pine cut between April 1, & September 1, must be removed from the sale area within two (2) weeks of cutting.
- Snowmobile/Ice Age Trails must be kept free and clear of slash during all phases of logging.

Bids must be accompanied by 10 percent of the bid price. Contracts must be returned within 30 days of sale. Additional 15 percent must be paid prior to sale start-up. This sale must be completed by December 31, 2028

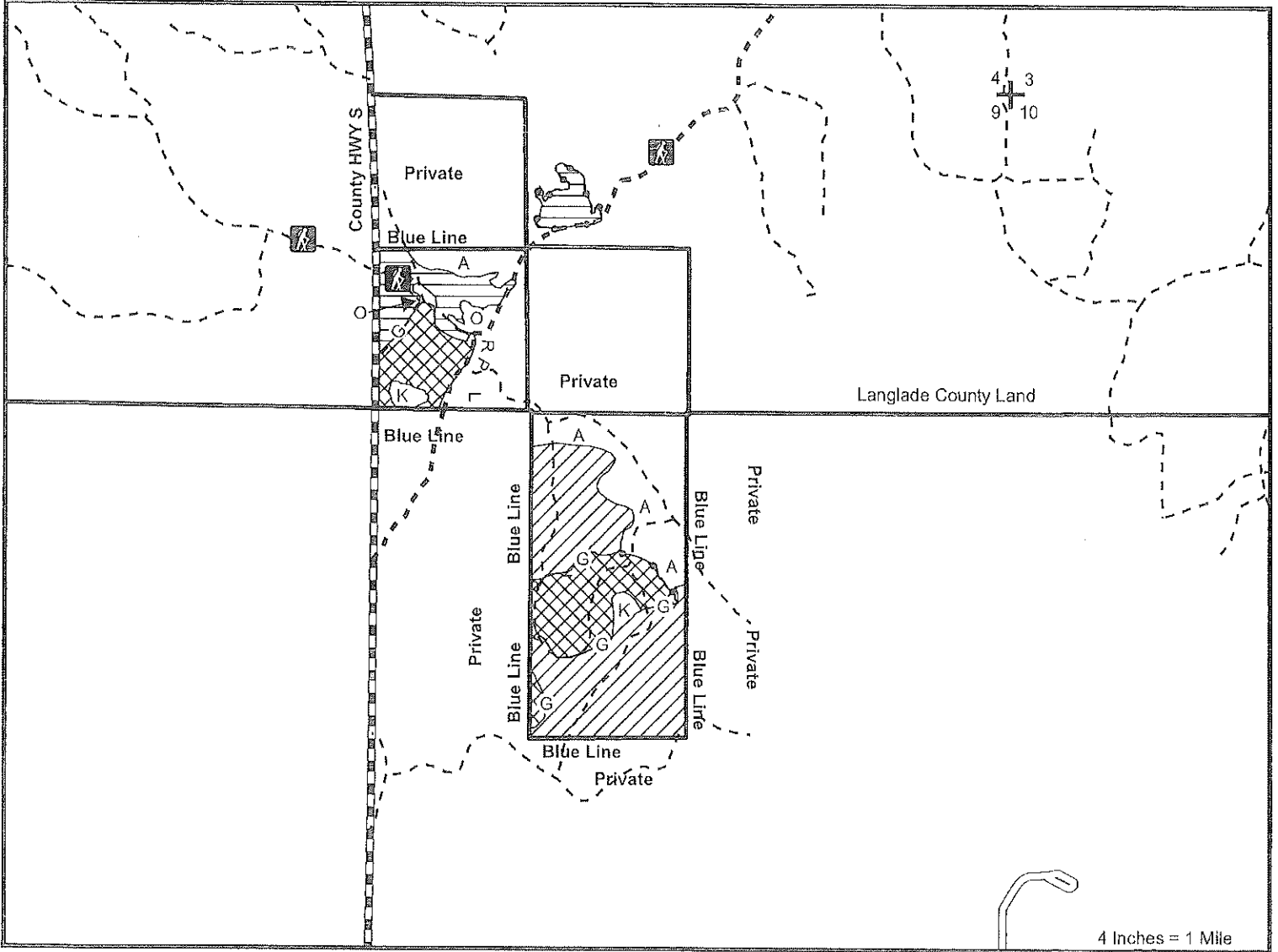
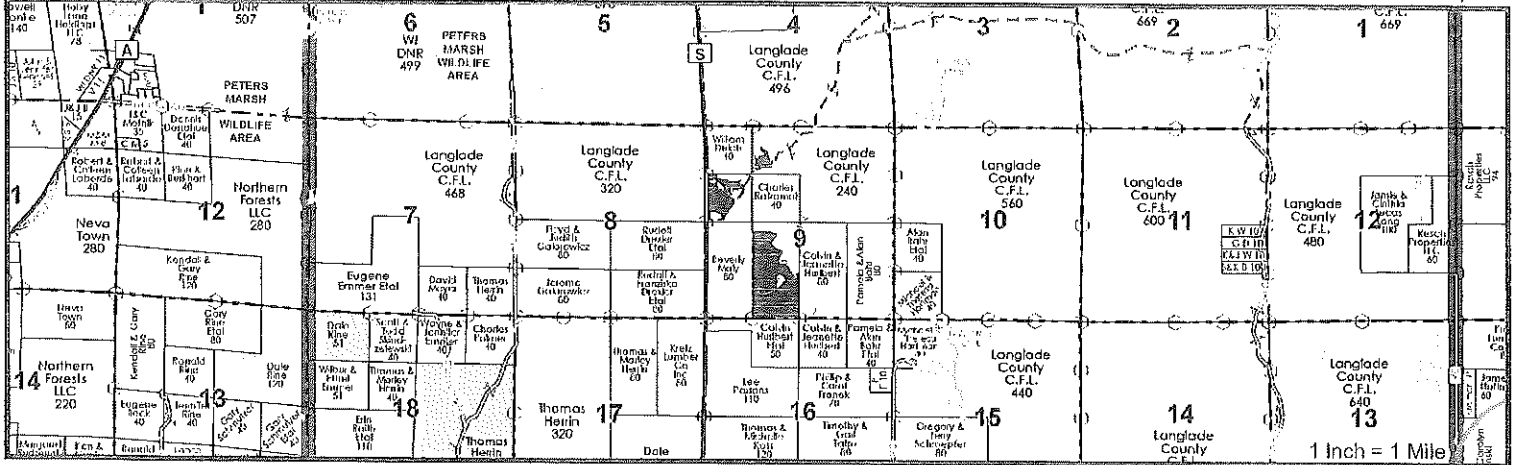

### Legend

Area 1 HWD Thinning - (36 acres)	Ice Age Trail	Green Paint Line
Area 2 Aspen Coppice - (24 acres)	Woods Road	Wetland
Area 3 Red Pine Thinning - (13 acres)	Snowmobile Trail	Grass Opening
County Highway	Red Paint Line or RPL	Aspen

This map is not a survey of any property depicted.

Langlade County Pulp and Timber Sale  
December 3, 2025

Job # 12  
 Location: Township of Upham : Compartment 118/110  
 W 1/2 SEC 29 T33N R11E, W1/2,SWNE, SEC 28 T33N R11E  
 45.31532, -89.13629  
 Cutting Area: Acres 107

Product/Species	Estimated		Minimum Bid Per Unit	Estimated		Bid Per Unit	Total
	Unit	Volume		Value			
Aspen	Tons	3445 ( 1498cds)	\$8.40	\$28,938.00			
Mixed Hardwood Pulp	Tons	320 (139cds)	\$9.70	\$3,104.00			
Balsam Fir Pulp	Tons	290 (125cds)	\$2.90	\$841.00			
Basswoods Pulp	Tons	132 (69cds)	\$3.00	\$396.00			
Hemlock	Tons	30 (13cds)	\$4.30	\$129.00			
Basswood Logs	MBF	25	\$145.00	\$3,625.00			
Mixed Hardwood Logs	MBF	9	\$163.00	\$1,467.00			
Red Maple	MBF	2	\$149.00	\$298.00			
Total Estimated				\$38,798.00			Total Bid
Bidder Name	_____			10% of Total Bid		_____	
Primary Contact	_____			Address	_____		
Phone Number	_____			Date	_____		

**Cutting Regulations:**

- Area 1 (53 Acres) Harvest all merchantable aspen, mixed hardwood, and balsam fir. Unmerchantable trees 1" and greater in diameter must be cut at the time of harvest. Leave all oak, pine, hemlock, and standing dead.
- Area 2 (54 Acres) Harvest all trees marked with orange paint and all merchantable ash, aspen, balsam fir, elm and ironwood.

**Special Regulations:**

Snowmobile Trails, if utilized, must be kept free and clear of slash during all phases of logging.

Contracts must be returned within 30 days of sale. Bids must be accompanied by 10 percent of the bid price. Additional 15 percent must be paid prior to sale start-up. This sale must be completed by December 31, 2028

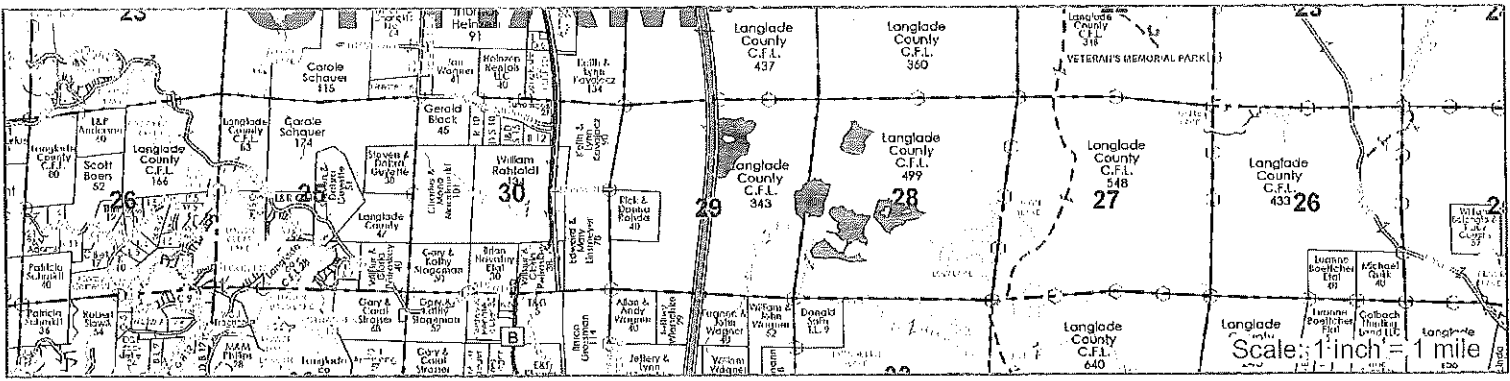

### Legend

- |        |      |                             |       |                  |     |                  |
|--------|------|-----------------------------|-------|------------------|-----|------------------|
| -----  | ==== | Snowmobile Trail            | O     | Grass Opening    | RPL | Red Paint Line   |
| -----  | ==== | State Highway               | ----- | Woods Road       | A   | Aspen            |
| Area 1 |      | HWD Thinning<br>(54 acers)  | ----- | Red Paint Line   | K   | Wetland          |
| Area 2 |      | Aspen Coppice<br>(53 acers) | —G—   | Green Paint Line | ≡   | Flowage Crossing |

This map is not a survey of any property depicted.



Langlade County Pulp and Timber Sale  
December 3, 2025

Job # 13

Location: Township of Evergreen: Compartment 186  
NWSE Section 2 T31N R13E  
45.195648, -88.830819

Cutting Area: 13 Acres Bidder must choose 5 inch top or whole tree option.

<b>5 Inch Top Option</b>						
Product/Species	Unit Volume	Estimated	Minimum Bid	Estimated	Bid Per Unit	Total
		Unit Volume	Per Unit	Value		
Spruce Pulp/Logs	Tons	830	(377 cds)	\$5.40	\$4,482.00	_____
Total Estimated Value of Accepted Bid				\$4,482.00	_____	_____
<b>Whole Tree Option</b>						
Product/Species	Unit Volume	Estimated	Minimum Bid	Estimated	Bid Per Unit	Total
		Unit Volume	Per Unit	Value		
Spruce Whole Tree	Tons	965	(377 cds)	\$4.79	\$4,622.35	_____
			(62 cds equivalent biomass)			
Total Estimated Value of Accepted Bid				\$4,622.35	_____	_____
Bid only one option (5 Inch Top or Whole Tree)					Total Bid	_____
Bidder Name _____					10% of Total Bid	_____
Primary Contact _____			Address _____			
Phone Number _____			Date _____			
email _____						

**Cutting Regulations:**

Area 1 (13 Acres) Harvest all merchantable spruce. Unmerchantable trees 1" and greater in diameter must be cut at the time of harvest.

**Special Regulations:**

Equestrian Trails– Trails must be kept free and clear of slash during all phases of logging.

Note: Plantation is impacted by spruce budworm and harvesting must be completed by December 31, 2026.

Bids must be accompanied by 10 percent of the bid price. Contracts must be returned within 30 days of sale. Additional 15 percent must be paid prior to sale start-up. This sale must be completed by December 31, 2026.

- MAP ON BACK -

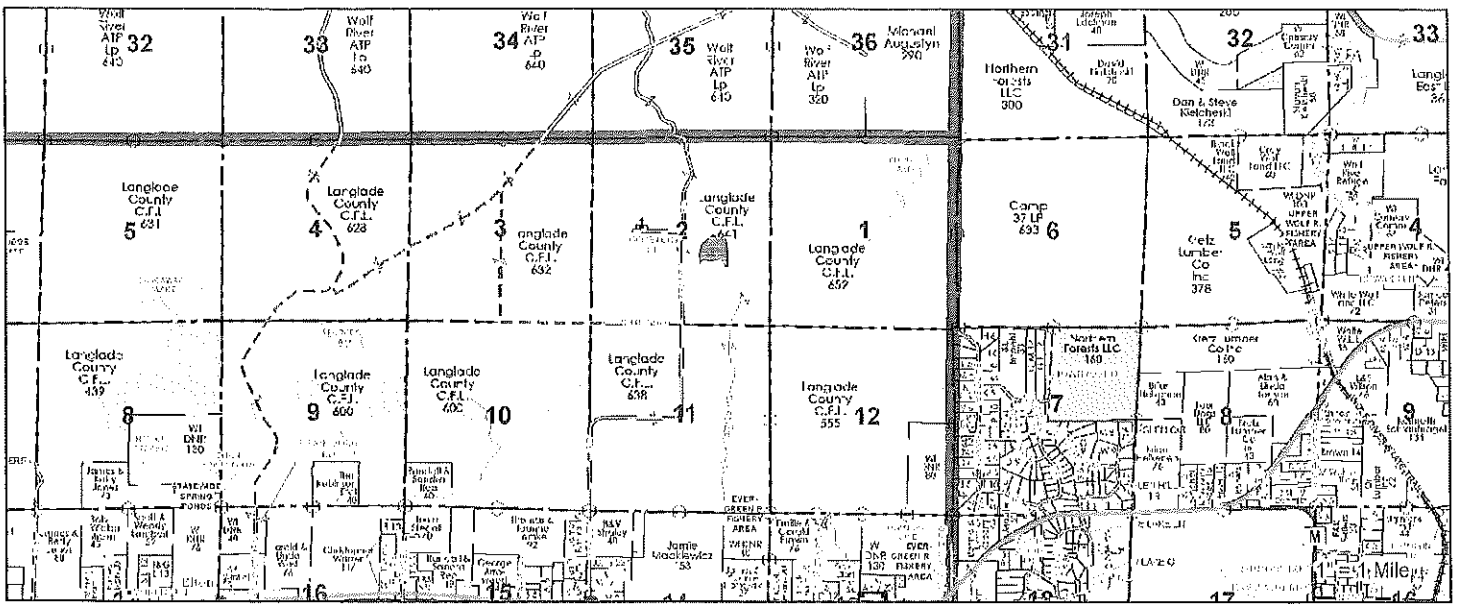



### Legend

 Area 1 (Spruce Clearcut) 13 acres

 Equestrian Trail

 Grass Opening

 Town Road

 Red Paint Line

 Section Center

 ATV Trail

RPL Red Paint Line

 Berm

 Woods Road

A Aspen Saplings

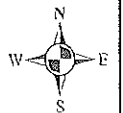

Langlade County Pulp and Timber Sale  
December 3, 2025

Job # 14

Location: Township of West Upham    Compartment: 92, 93  
SE1/4 Sect.7, NWSW Sect.17    T33N-R10E  
Lat. 45.353495N Long.-89.284508W

Cutting Area: 76 Acres

Product/Species	Estimated Unit Volume		Minimum Bid Per Unit	Estimated Value	Bid Per Unit	Total
Mixed Hardwood Pulp	Tons	1,310 (545 cds)	\$7.20	\$9,432.00	_____	_____
Basswood Pulp	Tons	190 (95 cds)	\$1.80	\$342.00	_____	_____
Aspen Pulp	Tons	60 (26 cds)	\$7.20	\$432.00	_____	_____
Balsam Fir Pulp	Tons	40 (17 cds)	\$2.90	\$116.00	_____	_____
White Ash Logs	MBF	65	\$165.00	\$10,725.00	_____	_____
Hard Maple Logs	MBF	30	\$289.00	\$8,670.00	_____	_____
Basswood Logs	MBF	20	\$105.00	\$2,100.00	_____	_____
Mixed Hardwood Logs	MBF	1	\$128.00	\$128.00	_____	_____
Total Estimated Value of Accepted Bid				\$31,945.00	_____	Total Bid
Bidder Name _____					10% of Total Bid _____	
Primary Contact _____			Address _____			
Phone Number _____			Date _____			
email _____						

**Cutting Regulations:**

Area 1 (76 Acres)    Harvest all trees marked with orange paint and all merchantable ash, aspen, ironwood and balsam fir with 2 or more pulp sticks.

**Special Regulations:**

Snowmobile/Ice Age Trail– Trails must be kept free and clear of slash during all phases of logging.

Note – Proposed access road with timber mat(for summer access) or frozen crossing location will be laid out with assistance of Forestry Department staff.

Bids must be accompanied by 10 percent of the bid price. Contracts must be returned within 30 days of sale. Additional 15 percent must be paid prior to sale start-up. This sale must be completed by Dec 31, 2028

- MAP ON BACK -

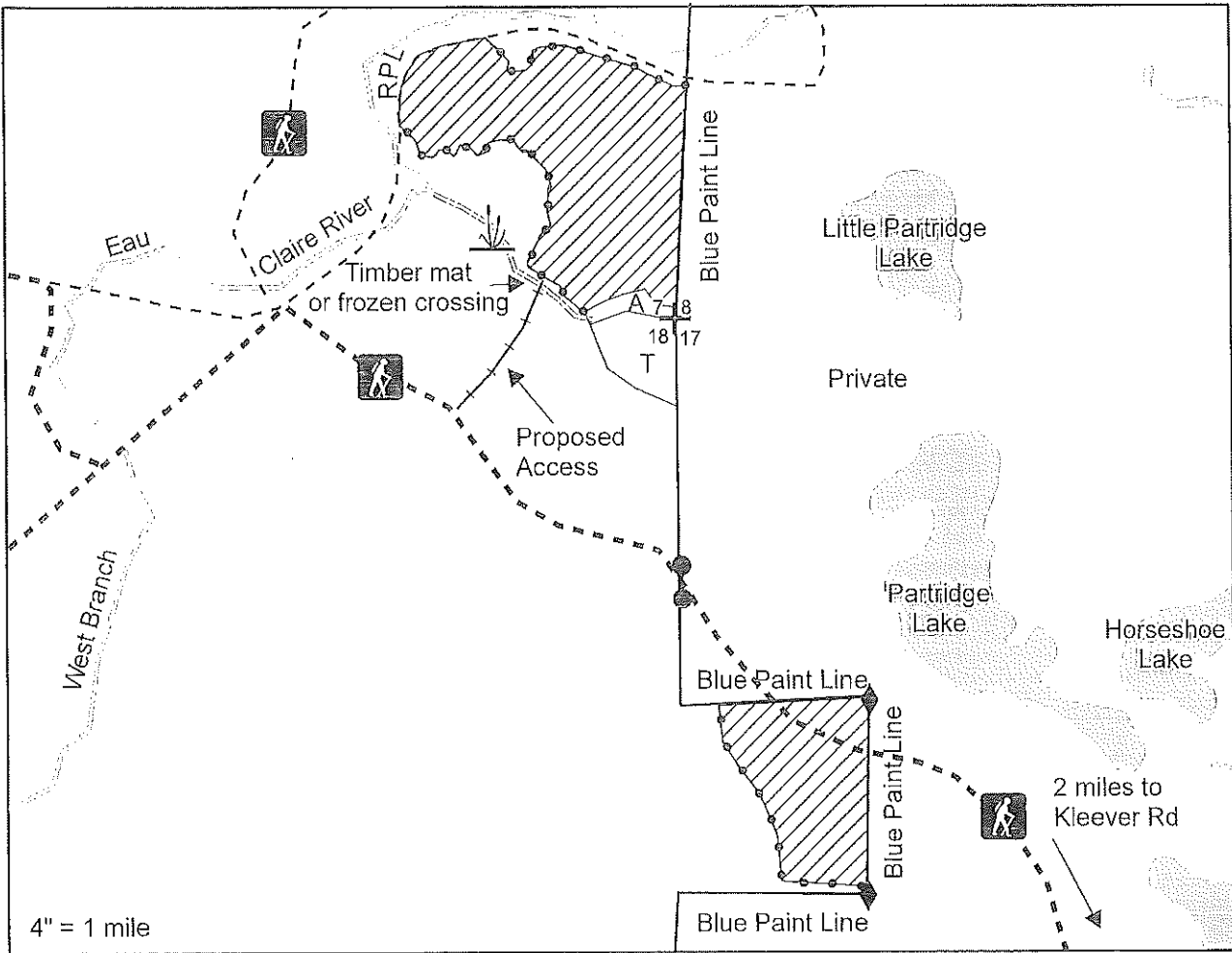
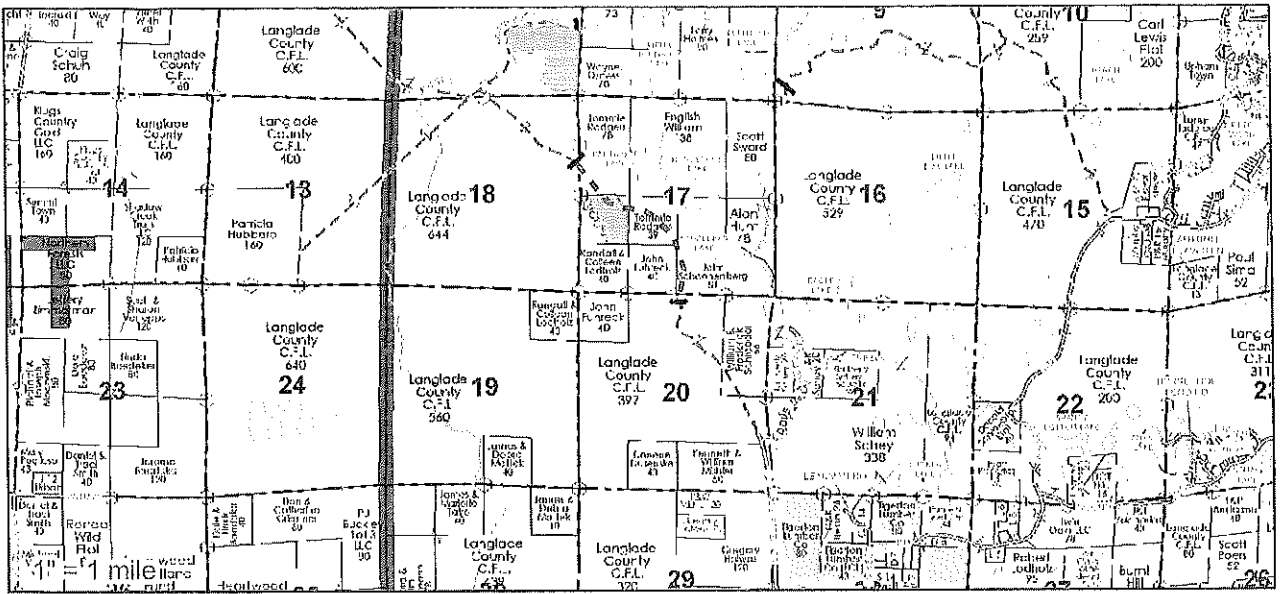

### Legend

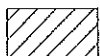

Area 1 Hardwood Selection (76 acres)

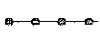

Red Paint Line

RPL

Red Paint Line

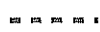

Snowmobile Trail

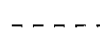

Woods Road



Ice Age Trail



Gate



T Conifer Swamp



Survey Marker



Wetland Drainage



A Young Aspen

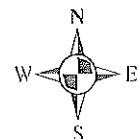

This map is not a survey of any property it depicts

Langlade County Pulp and Timber Sale  
December 3, 2025

Job # 15

Location: Township of Langlade: Compartment 138  
W1/2NW Section 5, SWNE, E1/2NE, NESE, NWSE Section 6 T32N-R13E  
45.2830; -88.9082

Cutting Area: 73 Acres

Product/Species	Estimated Unit Volume	Minimum Bid Per Unit	Estimated Value	Bid Per Unit	Total
Mixed Hardwood Pulp	Tons 575 (239 cds)	\$8.00	\$4,600.00		
Aspen Pulp	Tons 475 (206 cds)	\$7.60	\$3,610.00		
Basswood Pulp	Tons 260 (130 cds)	\$2.70	\$702.00		
Red Oak Pulp	Tons 155 (62 cds)	\$7.50	\$1,162.50		
Balsam Fir Pulp	Tons 70 (30 cds)	\$4.60	\$322.00		
Basswood Logs	MBF 22	\$156.00	\$3,432.00		
Hard Maple Logs	MBF 17	\$388.00	\$6,596.00		
Red Oak Logs	MBF 15	\$350.00	\$5,250.00		
Mixed Hardwood Logs	MBF 7	\$175.00	\$1,225.00		
Total Estimated Value of Accepted Bid			\$26,899.50		Total Bid
Bidder Name				10% of Total Bid	
Primary Contact				Address	
Phone Number				Date	
email					

**Cutting Regulations:**

Area 1 (58 Acres) Harvest all trees marked with orange paint and all merchantable ash, balsam fir and ironwood.

Area 2 (15 Acres) Harvest all merchantable aspen, mixed hardwood, oak and balsam fir. Unmerchantable trees 1" and greater in diameter must be cut at the time of harvest. Leave all green marked trees, pine, hemlock, spruce and standing dead.

**Special Regulations:**

Oak Wilt – To help prevent introducing oak wilt into this sale, no logging or road work will be permitted from April 15, thru July 15.

Invasive Species - Garlic Mustard is located on the woods roads and within the sale area. Loggers must clean equipment before and harvest to prevent spread.

Bids must be accompanied by 10 percent of the bid price. Contracts must be returned within 30 days of sale. Additional 15 percent must be paid prior to sale start-up. This sale must be completed by December 31, 2028.

- MAP ON BACK -

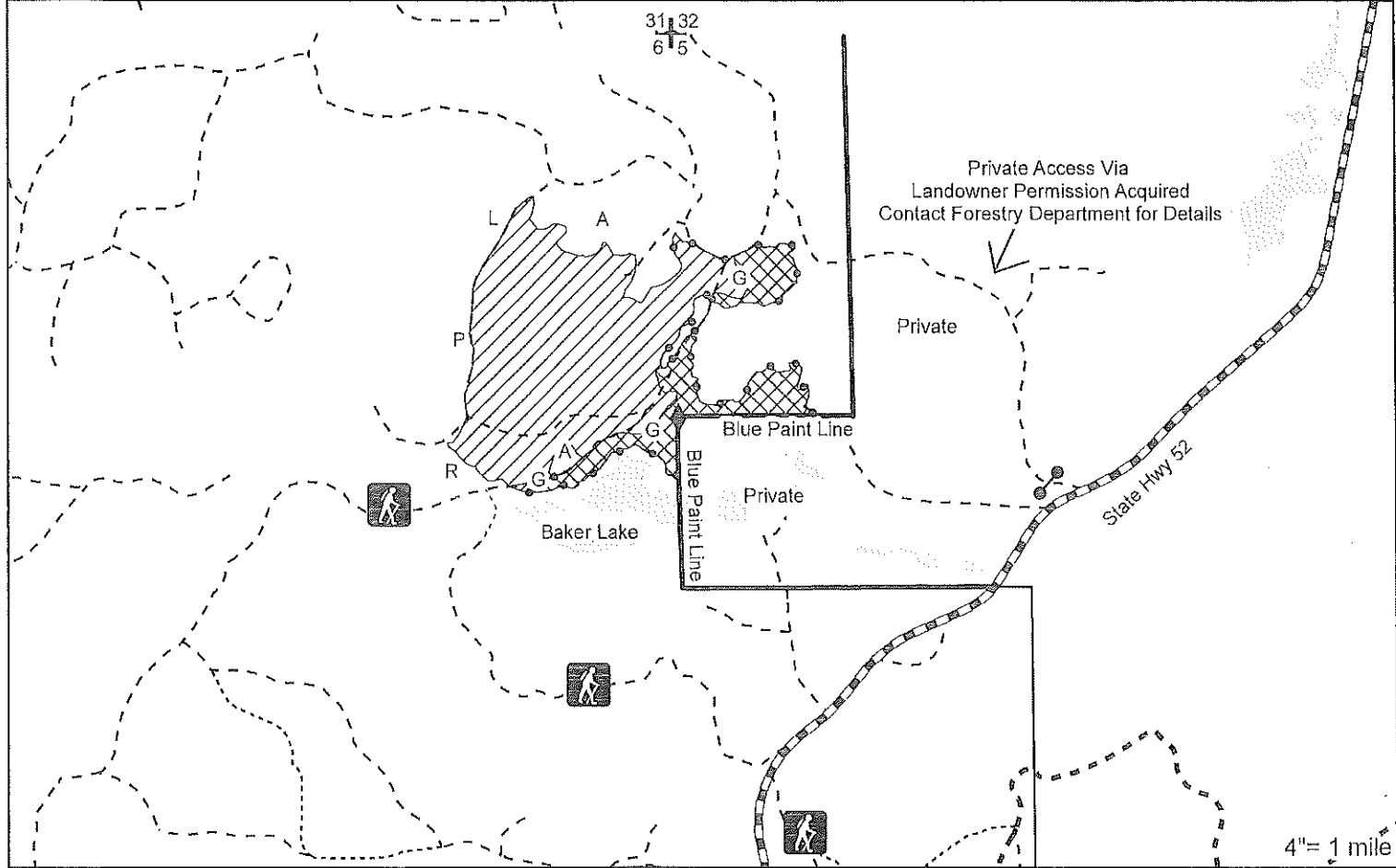
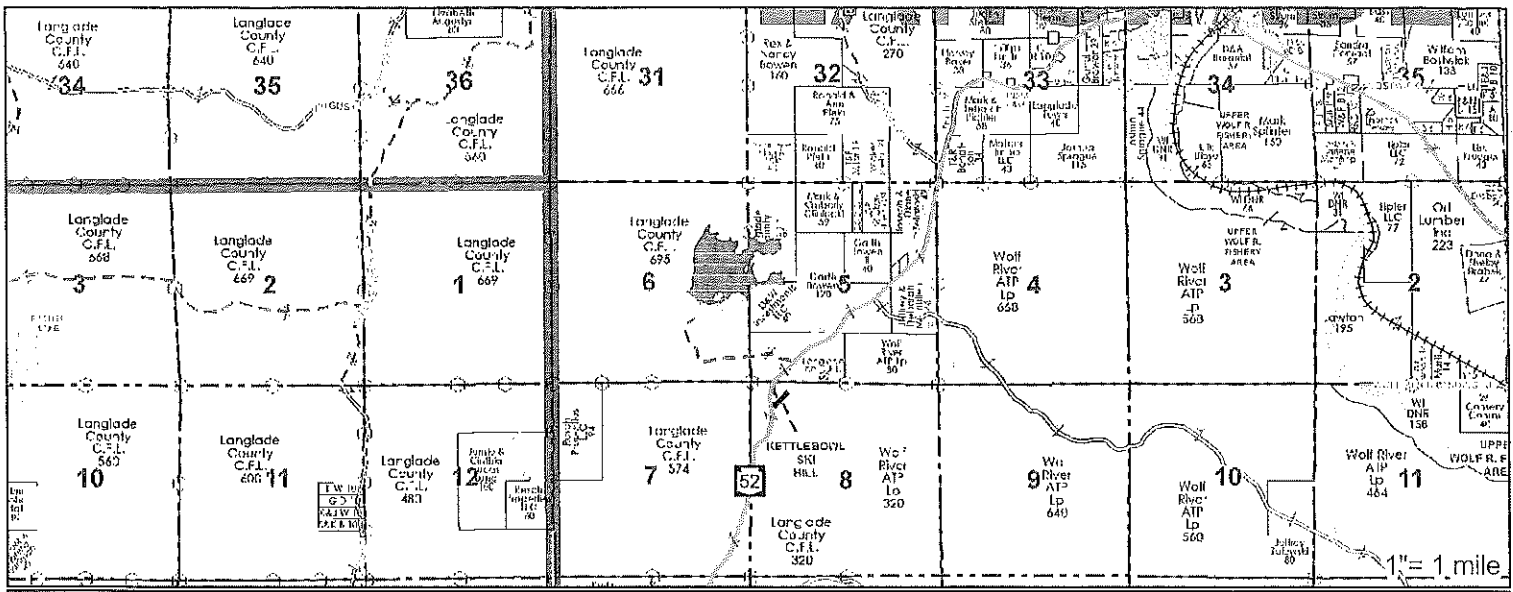

### Legend

- Area 1 - Northern Hardwood Single Tree Selection-(58 acres)
- Area 2 - Aspen Coppice-(15 acres)
- Highway
- Ice Age Trail
- Red Paint Line
- Green Paint Line
- Woods Roads
- Section Corner
- Gate
- Survey Marker

A Aspen

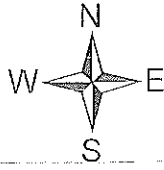

This map is not a survey of any property depicted